

AV 201

INSTRUCTIONS AND PARTS LIST

AV 201

PERFORMANCE

Air Consumption.....	0.7 l/s (1.5 cfm)
Vacuum At 5.5 bar	180 inches (Water gauge)
Noise Level.....	54 dB(A) at 1 metre

Figures quoted are nominal and may vary according to vacuum and supply setting.

DIMENSIONS

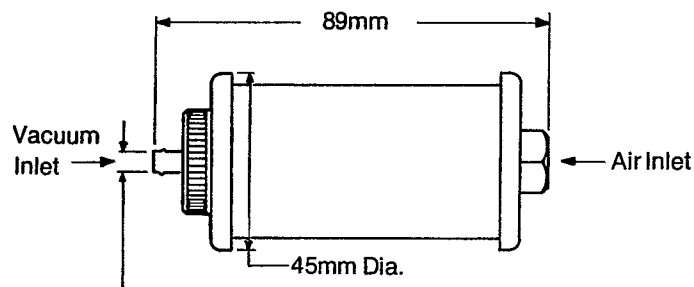

To Suit 4mm Bore Tube

INSTALLATION

The Vacuum Unit is light in weight, unobtrusive and easily installed alongside or under a workbench. A foot switch or similar can be installed to give the user a choice of suction.

Air Supply: Nominal 6 bar to be supplied as dry unlubricated air.

The air supply should be taken via a tee piece connected at a point between the filter and lubricator thus enabling the vacuum unit to receive filtered, oil free air.

OPERATION

To obtain a reduced vacuum unscrew the Bleed Screw (1) until the required vacuum is obtained.

PERIODIC MAINTENANCE

Unscrew Vacuum Connector (2) and remove Filter (4), clean by blowing through with an air line. Unscrew End Cover (9) from Vacuum Body (5) and separate the unit; inspect the Silencer (6), it must be clean and dry. If contaminated wash silencer in warm soapy water and allow to dry before assembling the unit.

VACUUM UNIT

Part No. 112063 — 1/8in. BSP

Item	Description	Part No.
1	Bleed Screw	112163
2	Vacuum Connector	112173
3	'O' Ring	111153
4	Filter	111443
5	Vacuum Body	112083
6	Silencer	112283
7	Exhaust Muffler	112093
8	Nozzle	112103
9	End Cover	112113
10	'O' Ring	500963
11	Adaptor Complete 1/8in. BSP	112123
—	Vacuum Tube	111223

Note: Adaptor 61103 can be fitted to item (11) to convert to 1/4in. NPT.

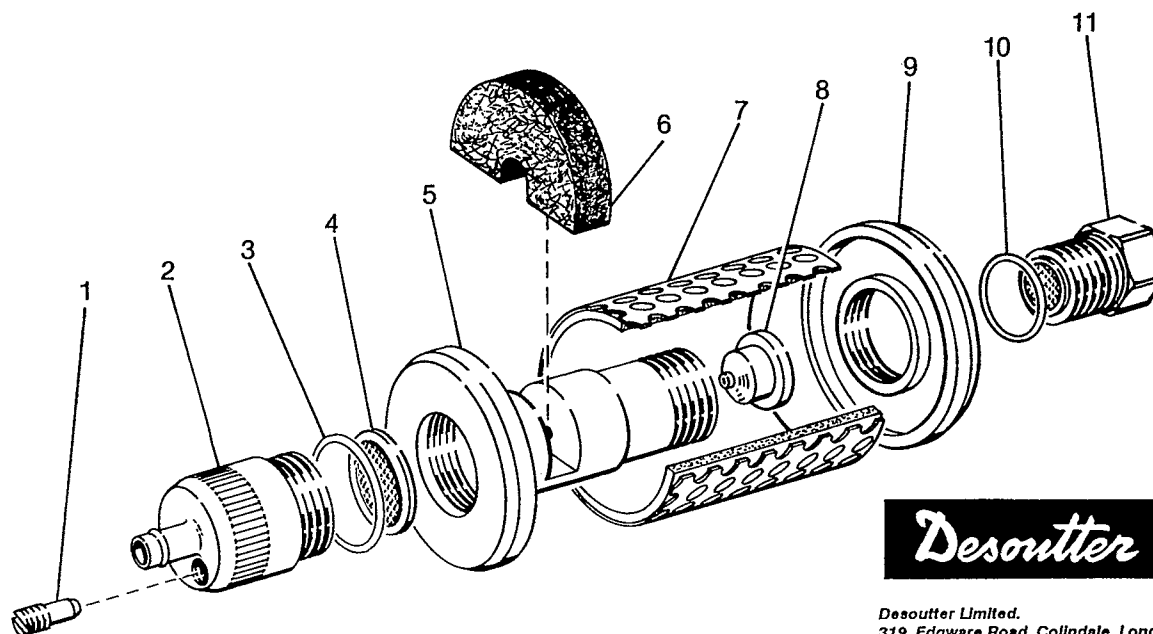

Desoutter Limited.
319, Edgware Road, Colindale, London NW9 6ND.
Telephone: 081-205 7050 Telex: 21392
Fax: 081-205 5167