

System 100 – HM Series

A

B

REMOTE START – TWO WAY SPECIFICATION

PIC REF	TOOL TYPE	AIR FLOW AT 6.3 BAR	AIR HOSE BORE	SOUND LEVEL	SOUND POWER LEVEL	VIBRATION
		cfm	in.	dB(A)	dB(A)	ms ⁻²
A	2HM5	35.0	3/8"	89	100	<2.5
B	2HM5 with Offset Head	35.0	3/8"	89	100	<2.5

REMOTE START – TWO WAY TORQUES (ft lb)

AIR PRESSURE		FREE SPEED			
bar	psi	150	350	550	950
6	87	–	–	30.24	18.44
5	75	–	36.88	24.34	15.49
4	58	–	29.50	19.18	11.80
3	43	–	22.13	14.75	8.85
2	29	36.88	15.49	10.33	6.64

Maximum stall torque 37.6 ftlb
Data obtained from a lubricated air line
Torque figures are to be used as a guide only
Pneumatic Control

Tools will start as soon as air is supplied to the forward or reverse port.

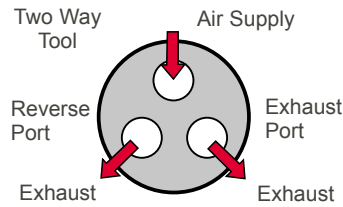

Lou Zampini & Associates

2 Douglas Pike, Rt. 7

Smithfield, RI 02917

1 800 353 4676

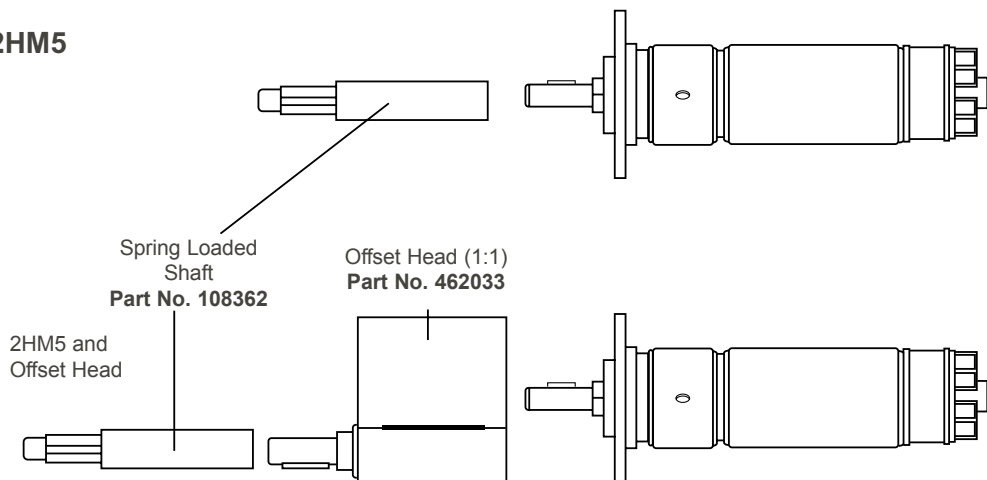
FAX 1 401 679 0165

HOW TO ORDER
2HM5

TOOL TYPE	PART NUMBER
2HM5-150	1309284
2HM5-350	1309444
2HM5-550	1309524
2HM5-950	1309604

HM Series – Dimensions

2HM5

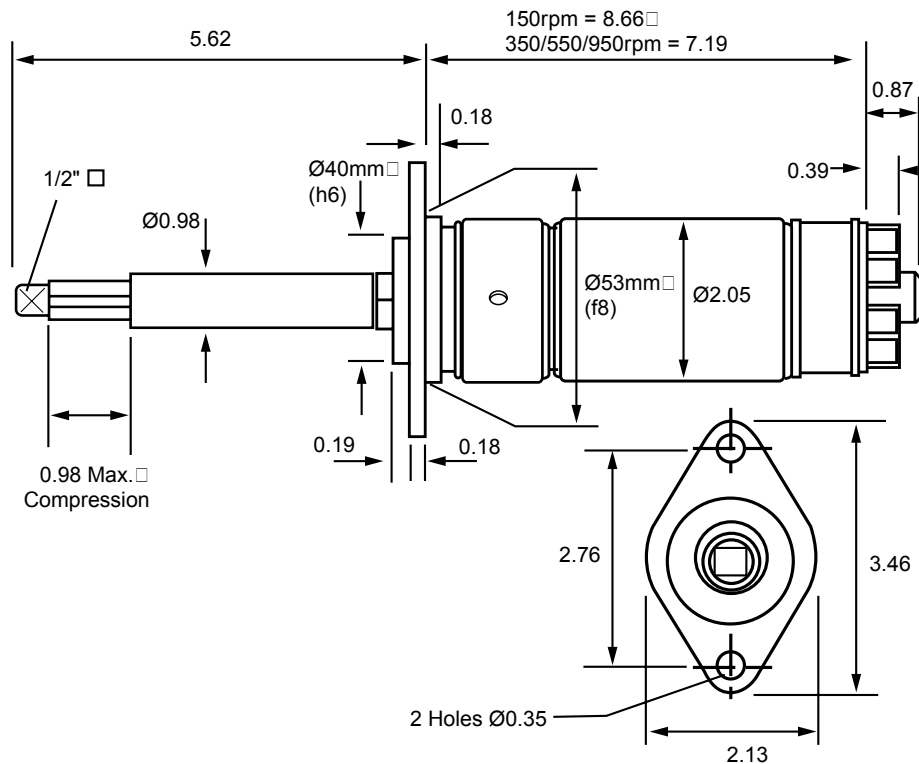

2HM5 and Offset Head

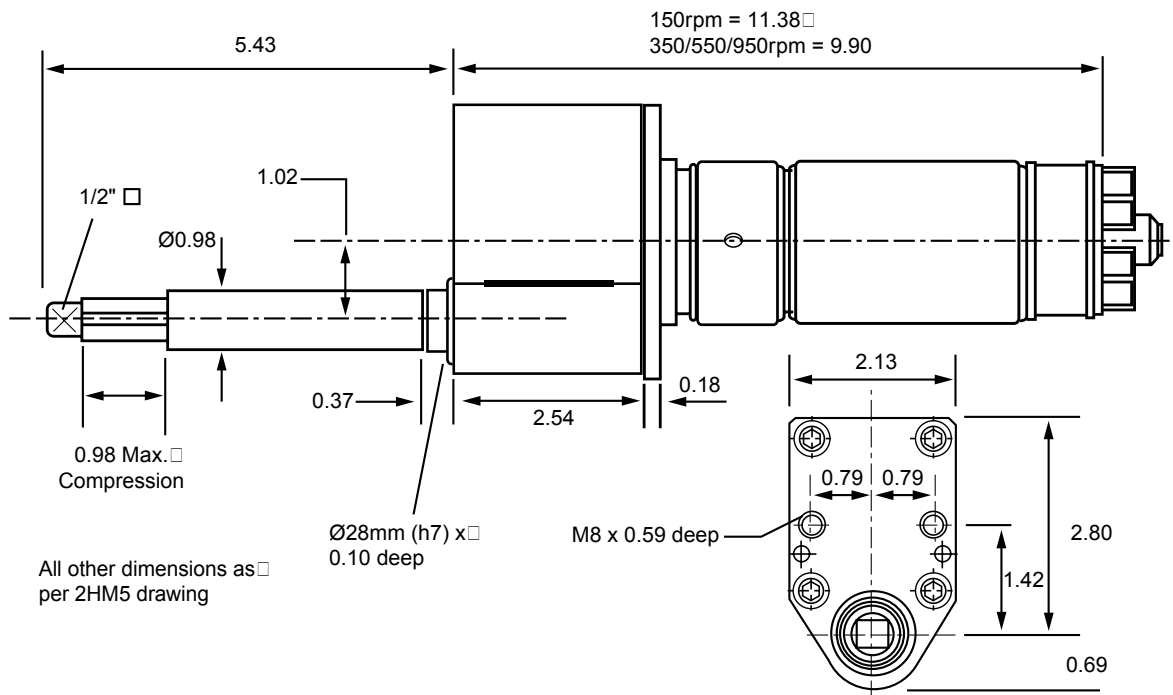

All dimensions are in inches calculated from measured millimeter values unless otherwise stated

System 100 – 2HM5-HT Series

A

REMOTE START – TWO WAY

PICTURE REF	TOOL TYPE	PART NUMBER	FREE SPEED ⁽¹⁾	TORQUE RANGE	AIR FLOW ⁽¹⁾	AIR HOSE BORE	AIR INLET	SOUND LEVEL	SOUND POWER LEVEL	VIBRATION
			r/min	ft lb	cfm	in.	NPT	dB(A)	dB(A)	ms ⁻²
A	2HM5-HT-230	1462654	230	22-62	35.0	3/8"	1/4"	89	100	<2.5
A	2HM5-HT-130	1462644	130	36-103	35.0	3/8"	1/4"	89	100	<2.5
A	2HM5-HT-80	1462634	80	55-129	35.0	3/8"	1/4"	89	100	<2.5

⁽¹⁾ Values taken at 6.3 bar inlet pressure

TORQUES (ft lb)

AIR PRESSURE		FREE SPEED		
bar	psi	80	130	230
6	87	–	103.26	62.69
5	75	125.39	84.82	51.63
4	58	99.57	66.38	40.57
3	43	73.76	51.63	33.19
2	29	55.32	36.88	22.13

Maximum stall torque 129 ftlb

Data obtained from a lubricated air line
Torque figures are to be used as a guide only

Pneumatic Control

Tools will start as soon as air is supplied to the forward or reverse port.

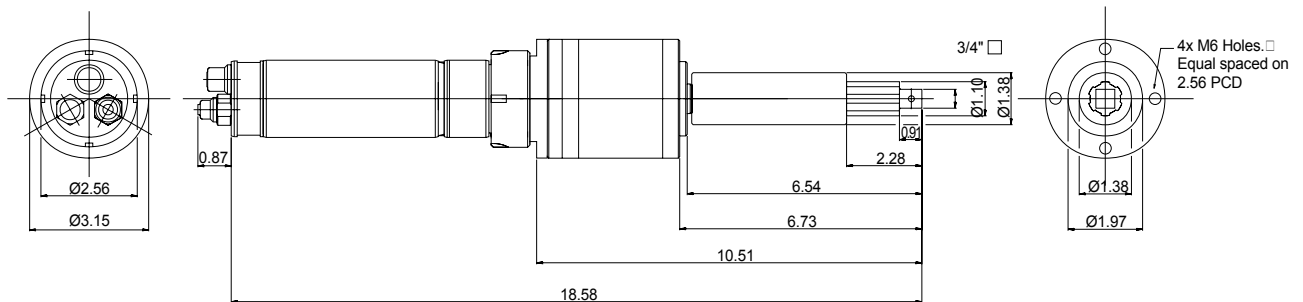
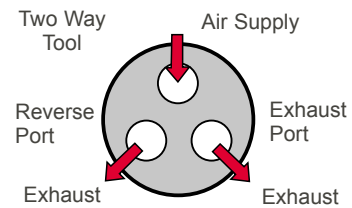

Collapsed View

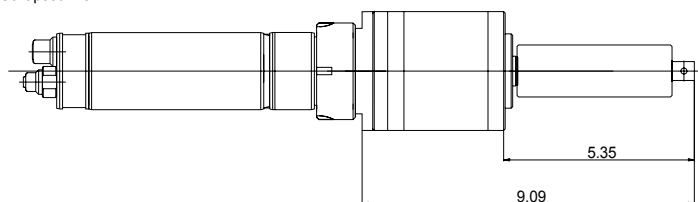

Weight 12.54lb (5.7kg)

All dimensions are in inches
calculated from measured millimeter
values unless otherwise stated

PHA1-XXX-SS44 Specification

Offset Head PHA1-XXX-SS44

Description

Offset gearbox for mounting to 2HM5-HT Torque Motor

Max rated torque up to 130ftlbs

Spindle Collapse 0.75"

Speed Ratio Approx. 1:1



Dimensions may change with torque rating

