

NEW Digital Transducers. Torque or Torque & Angle

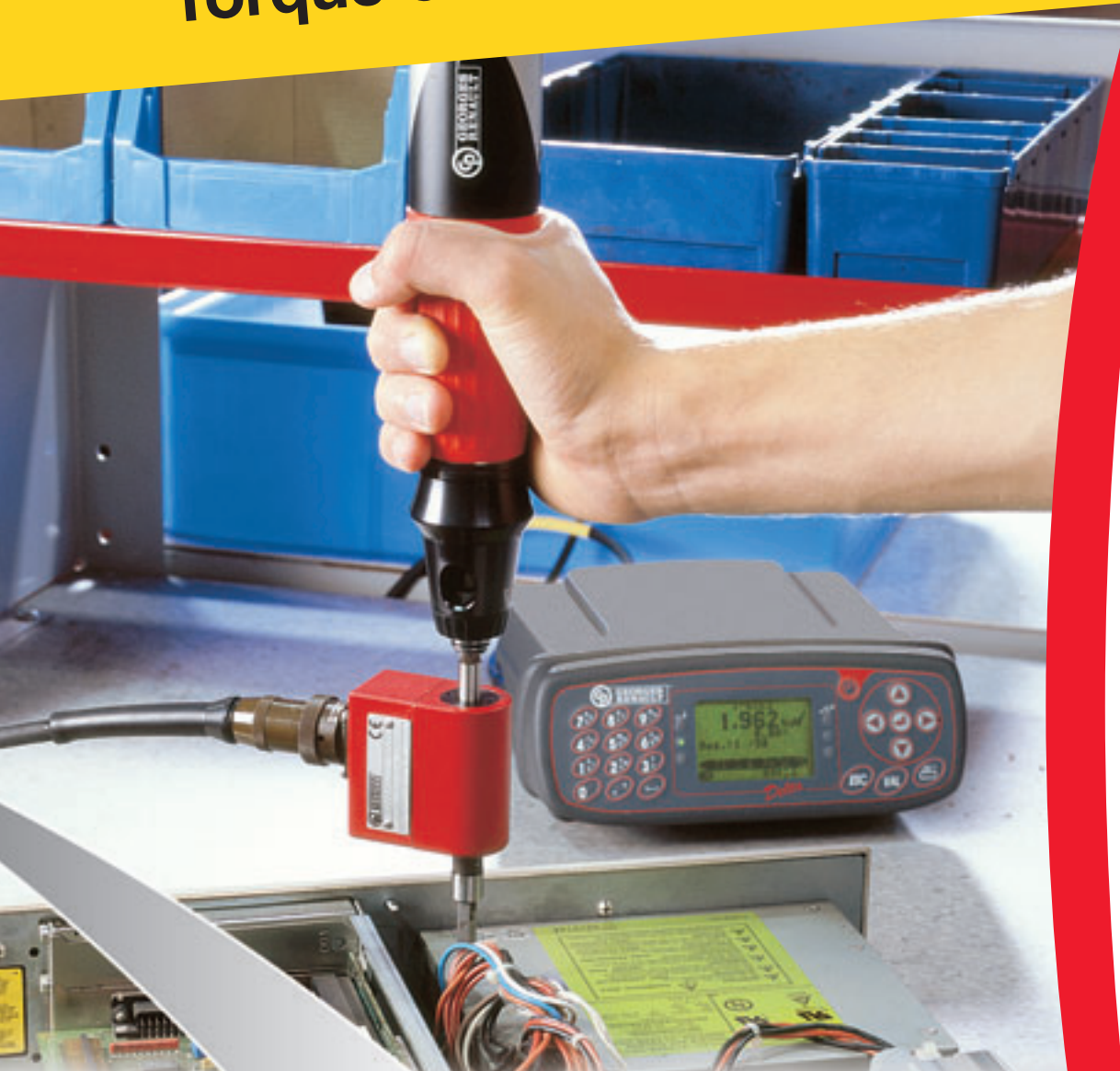

In-line Rotary Transducers



www.chicagopneumatic.com

Lou Zampini & Associates
2 Douglas Pike, Rt. 7
Smithfield, RI 02917
1 800 353 4676
FAX 1 401 679 0165

Digital Rotary Transducers "Torque or Torque & Angle"

The new DRT4 (torque) and DRT5 (torque & angle) transducers cover a torque range from 0.15 to 1400 Nm (0.11 to 1032 Ft.lb). DRT5 transducers offer a angle resolution down to 0.5°. The built-in memory stores all transducer calibration information and is accessed from the Sigma or Delta series data collectors.

Features:

- Torque range from 0.15 to 1400 Nm Transducers used in line with screwdrivers – pneumatic tools – impulse tools – electric nutrunners and spindles.
(0.11 to 1032 Ft.lb).
- Strain gauges transducer The most accurate and reliable type of torque transducer.
– sensitivity 2mV/V.
– accuracy +/-0.35% full scale.
- Built-in smart chip memory with: No need for transducer selection.
Calibration features: The data collector automatically recognises the transducer connected.
type of transducer – sensitivity – nominal load – serial number. No risk for the operator by selecting a wrong type of transducer.
Maintenance information:
date of last calibration – maximum torque applied on transducer.
- Unique contact system preventing the Transducers can be used in line with impulse tools,
common problem of "brush bounce". (not impact tools – use CC series transducers).
- Angle counting system 0.5° resolution Checks all types of joints, hard and soft.
- Same size for Torque or Torque & Angle transducers Easy access to all applications.
- Digital connection between data collector Cable length has no effect on accuracy.
and transducer. Reliability of torque values transmitted to the data collector.
Torque value converted to a digital signal Only one type of transducer cable needed.
in the transducer. Easy to recalibrate by modifying the sensitivity coefficient.
No hardware adjustment.

Benefits:

- Torque range from 0.15 to 1400 Nm Transducers used in line with screwdrivers – pneumatic tools – impulse tools – electric nutrunners and spindles.
(0.11 to 1032 Ft.lb).
- Strain gauges transducer The most accurate and reliable type of torque transducer.
– sensitivity 2mV/V.
– accuracy +/-0.35% full scale.
- Built-in smart chip memory with: No need for transducer selection.
Calibration features: The data collector automatically recognises the transducer connected.
type of transducer – sensitivity – nominal load – serial number. No risk for the operator by selecting a wrong type of transducer.
Maintenance information:
date of last calibration – maximum torque applied on transducer.
- Unique contact system preventing the Transducers can be used in line with impulse tools,
common problem of "brush bounce". (not impact tools – use CC series transducers).
- Angle counting system 0.5° resolution Checks all types of joints, hard and soft.
- Same size for Torque or Torque & Angle transducers Easy access to all applications.
- Digital connection between data collector Cable length has no effect on accuracy.
and transducer. Reliability of torque values transmitted to the data collector.
Torque value converted to a digital signal Only one type of transducer cable needed.
in the transducer. Easy to recalibrate by modifying the sensitivity coefficient.
No hardware adjustment.

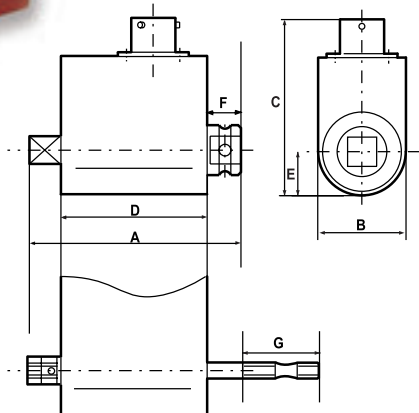
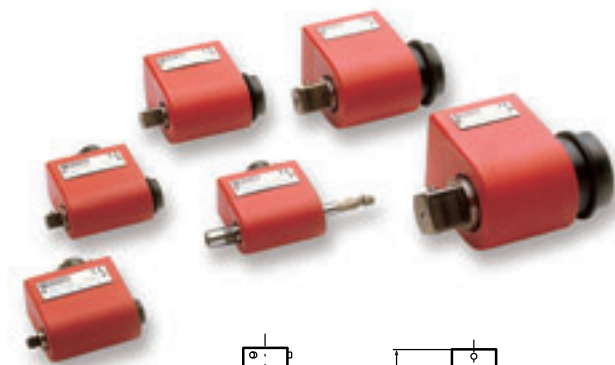

| OUTPUT | A mm | B mm | C mm | D mm | E mm | F mm | G mm |
|---------|---------|---------|---------|---------|---------|---------|---------|
| 1/4"Hex | 116 | 30 | 68 | 56 | 13 | 39 | 25.5 |
| 1/4"Sq | 71.5 | 30 | 71.5 | 56 | 13 | 6 | |
| 3/8"Sq | 77 | 30 | 74 | 56 | 15 | 8 | |
| 1/2"Sq | 87 | 42 | 82.5 | 58 | 21 | 12 | |
| 3/4"Sq | 106 | 52 | 93.5 | 60 | 26 | 21 | |
| 1"Sq | 125 | 63 | 104 | 64.5 | 31.5 | 29 | |

Torque transducers DRT4

| MODEL | PART NUMBER | TORQUE RANGE | | OUTPUT |
|---------------|---------------|--------------|-------------|----------|
| | | Nm | Ft.lb | Hex-sq |
| DRT 4 H 2 | 615 165 209 0 | 0.15 – 2 | 0.11 – 1.47 | Hex 1/4" |
| DRT 4 H 5 | 615 165 210 0 | 0.3 – 5 | 0.22 – 3.69 | Hex 1/4" |
| DRT 4 H 20 | 615 165 211 0 | 1.5 – 20 | 1.11 – 14.7 | Hex 1/4" |
| DRT 4 Sq 20 | 615 165 212 0 | 1.5 – 20 | 1.11 – 14.7 | Sq 1/4" |
| DRT 4 Sq 25 | 615 165 213 0 | 1.8 – 25 | 1.33 – 18.4 | Sq 3/8" |
| DRT 4 Sq 75 | 615 165 214 0 | 5.0 – 75 | 3.69 – 55.3 | Sq 3/8" |
| DRT 4 Sq 180 | 615 165 215 0 | 12 – 180 | 8.85 – 132 | Sq 1/2" |
| DRT 4 Sq 500 | 615 165 216 0 | 35 – 500 | 25.8 – 368 | Sq 3/4" |
| DRT 4 Sq 1400 | 615 165 217 0 | 95 – 1400 | 70.0 – 1032 | Sq 1" |

for transducers with specific national certification, change last digit to "3" (eg: 615 165 209 3)

Torque & Angle transducers DRT5

| MODEL | PART NUMBER | TORQUE RANGE | | OUTPUT |
|---------------|---------------|--------------|-------------|----------|
| | | Nm | Ft.lb | Hex-sq |
| DRT 5 H 2 | 615 165 218 0 | 0.15 – 2 | 0.11 – 1.47 | Hex 1/4" |
| DRT 5 H 5 | 615 165 219 0 | 0.3 – 5 | 0.22 – 3.69 | Hex 1/4" |
| DRT 5 H 20 | 615 165 220 0 | 1.5 – 20 | 1.11 – 14.7 | Hex 1/4" |
| DRT 5 Sq 20 | 615 165 221 0 | 1.5 – 20 | 1.11 – 14.7 | Sq 1/4" |
| DRT 5 Sq 25 | 615 165 222 0 | 1.8 – 25 | 1.33 – 18.4 | Sq 3/8" |
| DRT 5 Sq 75 | 615 165 223 0 | 5.0 – 75 | 3.69 – 55.3 | Sq 3/8" |
| DRT 5 Sq 180 | 615 165 224 0 | 12 – 180 | 8.85 – 132 | Sq 1/2" |
| DRT 5 Sq 500 | 615 165 225 0 | 35 – 500 | 25.8 – 368 | Sq 3/4" |
| DRT 5 Sq 1400 | 615 165 226 0 | 95 – 1400 | 70.0 – 1032 | Sq 1" |

for transducers with specific national certification, change last digit to "3" (eg: 615 165 218 3)

OPTIONAL ACCESSORIES

Cables (same to DRT 4 or DRT 5)

| | PART NUMBER |
|--------------|---------------|
| • 2 m | 615 917 430 0 |
| • 5 m | 615 917 433 0 |
| • 2 m coiled | 615 917 432 0 |



Chicago
Pneumatic™