



Companies within  
the Atlas Copco Group

*Sales Contacts:*

- **Asia, Australia,  
New Zealand, Japan**  
telephone (852) 235 70 963  
facsimile (852) 276 31 875
- **Austria**  
telephone (43) 2246 4677  
facsimile (43) 2246 4682
- **Belgium, Luxembourg**  
telephone (32) 2 660 4938  
facsimile (32) 2 672 6092
- **France**  
telephone (33) 2 40 80 20 00  
facsimile (33) 2 40 33 27 07
- **Germany**  
telephone (49) 6181 4110  
facsimile (49) 6181 411184
- **International**  
telephone (44) 1442 344 300  
facsimile (44) 1442 344 602
- **Italy**  
telephone (39) 039 244 101  
facsimile (39) 039 465 5025
- **Netherlands**  
telephone (31) 765 878 668  
facsimile (31) 765 878 825
- **Portugal**  
telephone (35) 11 3158792  
facsimile (35) 11 3158793
- **South Africa**  
telephone (27) 11 821 9300  
facsimile (27) 11 821 9360
- **Spain**  
telephone (34) 91 590 3152  
facsimile (34) 91 590 3161
- **United Kingdom**  
telephone (44) 1442 344 301  
facsimile (44) 1442 344 600
- **U.S.A., Canada and Mexico**  
telephone (1) 800 867 2442  
facsimile (1) 800 232 6611

# Accessories

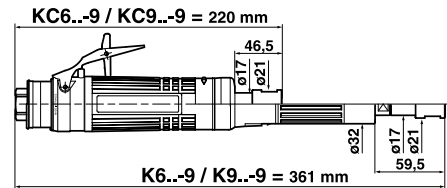
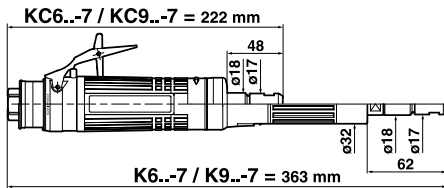

## K6..- / K9..- / KC6..- / KC9..-

### ACCESSORIES INCLUDED

ITEM	COLLET CNOMO	COLLET SERIES 200
1	CNOMO collet $\varnothing$ 6 mm	615 526 049 0
2	Series 200 resilient collet, $\varnothing$ 5.55 to 6.35 mm (1/4")	615 526 063 0
•	Exhaust hose L = 1.5 m (60")	615 875 113 0
•	Clamp	615 873 415 0
•	3/8" air hose nipple for 10 mm ID hose	615 704 017 0
•	Flat wrench 14 mm	615 801 005 0
•	Flat wrench 19 mm (3/4")	615 801 076 0

### OPTIONAL ACCESSORIES

ITEM	K6..-/K9..-	KC6..-/KC9..-
3	Suction cap	615 396 013 0
4	Suction cap	615 396 023 0
5	Suction cap	615 396 014 0
6	Diamond burr $\varnothing$ 7.2 mm, shank $\varnothing$ 6 mm (28 000 rpm max)	615 860 051 0
7	Diamond cylinder $\varnothing$ 27 mm, shank $\varnothing$ 6 mm (20 000 rpm max)	615 860 003 0
8	Diamond cylinder $\varnothing$ 52 mm, shank $\varnothing$ 6 mm (15 000 rpm max)	615 860 004 0

### OTHER OPTIONAL ACCESSORIES

ITEM	PART NO.
9	Complete silencer kit
10	Inlet hose assembly L = 1.7 m (67") 3/8"M - 3/8"F - $\varnothing$ 10 mm
11	Reinforced cloth-lined exhaust hose L = 0.75 m (30")

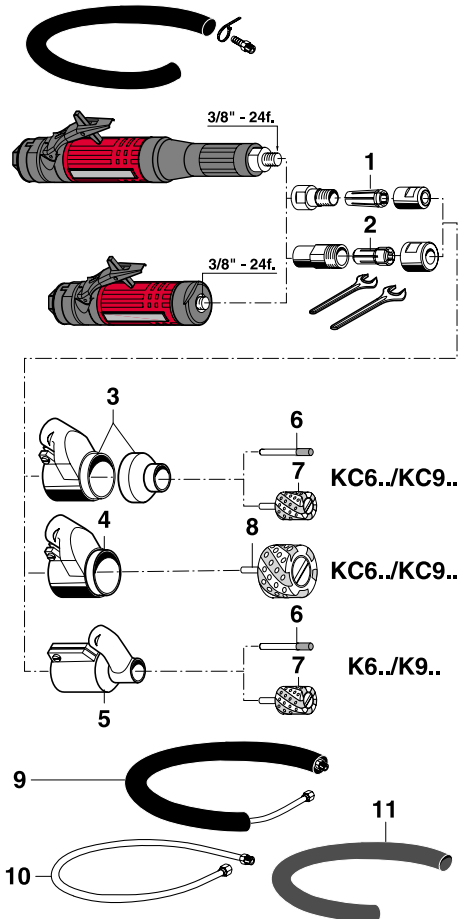

**Lou Zampini & Associates**  
 2 Douglas Pike, Rt. 7  
 Smithfield, RI 02917  
 1 800 353 4676  
 FAX 1 401 679 0165



# Dust extraction systems for straight grinders

600 - 900 Watts (0.8 - 1.21 hp) - 12 000 to 28 000 rpm



A

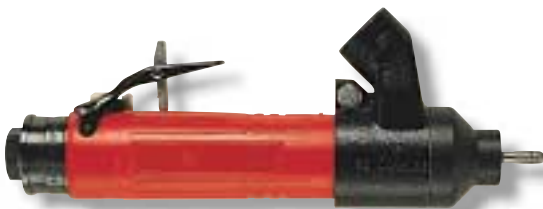

B



B



615 396 014 0  
Vacuum hose,  
ID 25 mm  
(1")



615 396 013 0  
Vacuum hose,  
ID 32 mm  
(1-1/4")



615 396 023 0  
Vacuum hose,  
ID 32 mm  
(1-1/4")

Caution: comply with the speeds recommended by component and abrasive manufacturers

PICTURE REF	MODEL	PART NUMBER		SUCTION CAP ASSEMBLY	FREE SPEED	POWER		WEIGHT		AIR INLET THREAD	
		CNOMO COLLET (-7)	SERIES 200 COLLET (-9)			W	hp	kg	lb.		
					rpm					inch	
A	K628-	615 170 107 0	615 170 150 0	+	615 396 014 0	28 000	600	0.80	1.3	2.9	3/8
A	K624-	615 170 106 0	615 170 151 0	+	615 396 014 0	24 000	600	0.80	1.3	2.9	3/8
A	K922-	615 170 119 0	615 170 152 0	+	615 396 014 0	22 000	900	1.21	1.4	3.1	3/8
A	K619-	615 170 105 0	615 170 153 0	+	615 396 014 0	19 000	600	0.80	1.3	2.9	3/8
A	K918-	615 170 117 0	615 170 154 0	+	615 396 014 0	18 000	900	1.21	1.4	3.1	3/8
A	K615-	615 170 104 0	615 170 155 0	+	615 396 014 0	15 000	600	0.80	1.3	2.9	3/8
A	K915-	615 170 114 0	615 170 156 0	+	615 396 014 0	15 000	900	1.21	1.4	3.1	3/8
A	K912-	615 170 110 0	615 170 157 0	+	615 396 014 0	12 000	900	1.21	1.4	3.1	3/8
B	KC628-	615 170 126 0	615 170 158 0	+	615 396 013 0 or 615 396 023 0	28 000	600	0.80	0.9	2.0	3/8
B	KC624-	615 170 125 0	615 170 159 0	+	615 396 013 0 or 615 396 023 0	24 000	600	0.80	0.9	2.0	3/8
B	KC922-	615 170 130 0	615 170 160 0	+	615 396 013 0 or 615 396 023 0	22 000	900	1.21	1.0	2.2	3/8
B	KC619-	615 170 124 0	615 170 161 0	+	615 396 013 0 or 615 396 023 0	19 000	600	0.80	0.9	2.0	3/8
B	KC918-	615 170 129 0	615 170 162 0	+	615 396 013 0 or 615 396 023 0	18 000	900	1.21	1.0	2.2	3/8
B	KC615-	615 170 123 0	615 170 163 0	+	615 396 013 0 or 615 396 023 0	15 000	600	0.80	0.9	2.0	3/8
B	KC915-	615 170 128 0	615 170 164 0	+	615 396 013 0 or 615 396 023 0	15 000	900	1.21	1.0	2.2	3/8
B	KC912-	615 170 127 0	615 170 165 0	+	615 396 013 0 or 615 396 023 0	12 000	900	1.21	1.0	2.2	3/8

# Accessories

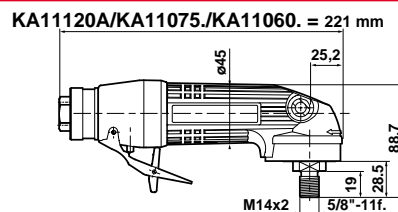
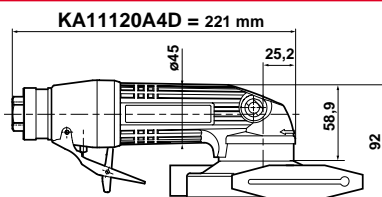
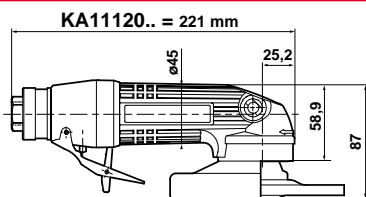

## KA11120.5K / KA11120A. / KA11120B5. / KA11075. / KA11060.

### ACCESSORIES INCLUDED

ITEM	KA11120A.	
	KA11120H5K	KA11120B5.
• Exhaust hose L = 1.5 m (60")		615 875 1130
• Clamp		615 873 415 0
• 3/8" air hose nipple for 13 mm ID hose		615 704 027 0
1 Side handle		615 576 038 0
2 Vibration-damping side handle	615 576 066 0	
3 Complete silencer kit	615 396 166 0	
4 Thermal insulating sleeve	615 570 412 0	

Grinders are supplied with their flanges, wheel guards and service keys

### OPTIONAL ACCESSORIES

ITEM	For grinding or sanding with semirigid disc for metallic materials	
	KA11120A5K	KA11120H5K KA11120A5.
A Suction cap for grinding wheel and semirigid disc $\varnothing$ 127 mm (5")	615 396 009 0	615 396 009 0
5 Backing pad with nut M14 (max: 12 000 rpm)*	615 990 129 0	

\* Sanding with semirigid disc

ITEM	For sanding metallic materials	
	KA11120A	KA110..A / B
B Suction cap for standard abrasive disc $\varnothing$ 127 mm (5")	615 396 010 0	
6 Ventilated backing pad with nut M14 and 5/8" (max: 12 000 rpm)	615 990 127 0	

ITEM	For sanding non metallic materials	
	KA11120A	KA110..A / B
C Suction cap for standard abrasive disc $\varnothing$ 127 mm (5")	615 396 012 0	
6 Ventilated backing pad with nut M14 and 5/8" (max: 12 000 rpm)	615 990 127 0	

### OTHER OPTIONAL ACCESSORIES

ITEM	PART NO.
7 Diamond disc $\varnothing$ 100 mm (4")	615 860 002 0
8 Complete silencer kit	615 396 166 0
9 Inlet hose assembly L = 1.7 m (67") 3/8"M - 3/8"F - $\varnothing$ 13 mm	615 804 064 0
10 Reinforced cloth-lined exhaust hose L = 0.75 m (30")	615 875 116 0
11 Vibration-damping side handle	615 576 066 0
12 Thermal insulating sleeve	615 570 412 0
13 Grease gun (capacity 24 g.)	615 990 149 0
• Lubricant for bevel gear (1 kg)	615 990 148 0

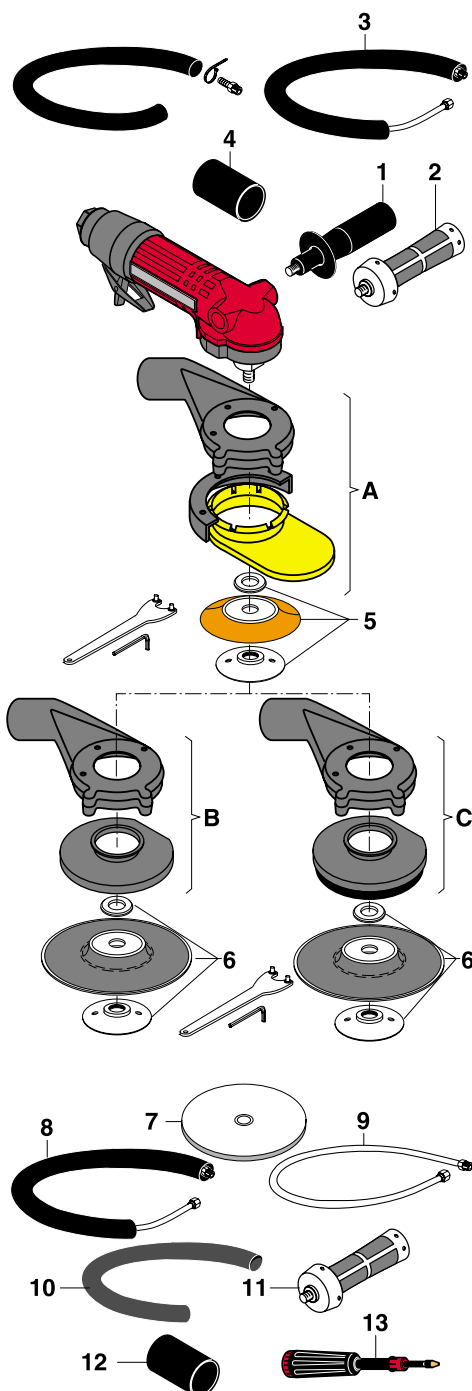

# Dust extraction systems for angle grinders and sanders Ø 100 mm (4") - Ø 127 mm (5")

900 to 1 100 Watts (1.21 to 1.5 hp) - 6 000 to 12 000 rpm



A

Adjustable lever



B

Dust extraction casing for diamond disc Ø 100 mm (4")  
Vacuum hose ID 25 mm (1")

For wheel or  
semirigid abrasive  
Metallic materials

For standard  
abrasive disc  
Metallic materials

For standard  
abrasive disc  
Non metallic materials



C



615 396 009 0



615 396 010 0



615 396 012 0

Vacuum hose, ID 38 mm (1-1/2")

Caution: comply with the speeds recommended by component and abrasive manufacturers

PICTURE REF	MODEL	PART NUMBER	SUCTION CAP ASSEMBLY	FREE SPEED rpm	THREADED SPINDLE	POWER		WEIGHT		AIR INLET THREAD inch
						W	hp	kg	lb.	
<b>ANGLE GRINDERS</b>										
A	KA11120H5K	615 170 028 0	+ 615 396 009 0	12000	HEX	1100	1.50	1.7	3.7	3/8
A	KA11120A5K	615 170 054 0	+ 615 396 009 0	12000	M14x2	1100	1.50	1.7	3.7	3/8
A	KA11120A5	615 170 053 0	+ 615 396 009 0	12000	M14x2	1100	1.50	1.7	3.7	3/8
A	KA11120B5	615 170 056 0	+ 615 396 009 0	12000	5/8"-11f.	1100	1.50	1.7	3.7	3/8
A	KA11120A5F	615 170 052 0	+ 615 396 009 0	12000	M14x2	1100	1.50	1.7	3.7	3/8
A	KA11120B5F	615 170 055 0	+ 615 396 009 0	12000	5/8"-11f.	1100	1.50	1.7	3.7	3/8
B	KA11120A4D	615 170 059 0	Supplied with dust extraction casing	12000	M14x2	1100	1.50	2.0	4.4	3/8
<b>ANGLE SANDERS</b>										
C	KA11120A	615 170 051 0	+ 615 396 010 0 or 615 396 012 0	12000	M14x2	1100	1.50	1.4	3.1	3/8
C	KA11075A	615 170 061 0	+ 615 396 010 0 or 615 396 012 0	7500	M14x2	1000	1.34	1.4	3.1	3/8
C	KA11075B	615 170 062 0	+ 615 396 010 0 or 615 396 012 0	7500	5/8"-11f.	1000	1.34	1.4	3.1	3/8
C	KA11060A	615 170 063 0	+ 615 396 010 0 or 615 396 012 0	6000	M14x2	900	1.21	1.4	3.1	3/8
C	KA11060B	615 170 064 0	+ 615 396 010 0 or 615 396 012 0	6000	5/8"-11f.	900	1.21	1.4	3.1	3/8

# Accessories

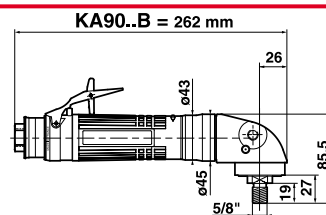
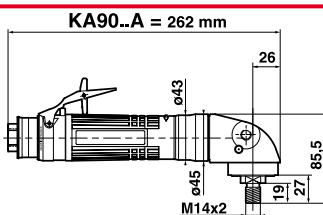
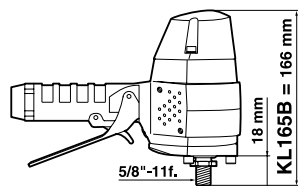

## KL165B / KA90..A / KA90..B

### ACCESSORIES INCLUDED

	KL165B	KA90..A	KA90..B
• Rear flange	615 503 107 0		
• 1/2" air hose nipple for 13 mm ID hose	615 704 016 0		
• Exhaust hose L = 1.5 m (60")		615 875 113 0	
• Clamp		615 873 415 0	
• 3/8" air hose nipple for 10 mm ID hose		615 704 017 0	
• Grip		615 576 069 0	

### OPTIONAL ACCESSORIES

	KL165B non metallic materials Fibre disc	KL165B metallic materials Fibre disc
For sanding:		
• Complete kit (including Item 1-2-3)	615 399 364 0	615 399 365 0
1 Assembled dust collector	615 399 359 0	615 399 360 0
2 Washer Z16U	615 642 050 0	615 642 050 0
3 Rigid backing pad with nut (max: 8500 rpm)	615 990 134 0	615 990 134 0
• Pin wrench, 35 mm (1-3/8")	615 802 010 0	615 802 010 0
• Hex. key 8 mm (5/16")	615 802 061 0	615 802 061 0

ITEM	KA90..A / B ø 180 mm (7")
A Suction cap	615 396 125 0
4 Rigid backing pad with nut M14 and 5/8" ø 180 mm (7") (max: 8 500 rpm)	615 990 134 0
• Pin wrench, 35 mm (1-3/8")	615 802 010 0

ITEM	KA90..A / B ø 180 mm (7")
B Suction cap	615 396 126 0
4 Rigid backing pad with nut M14 and 5/8" ø 180 mm (7") (max: 8 500 rpm)	615 990 134 0
• Pin wrench, 35 mm (1-3/8")	615 802 010 0

### OTHER OPTIONAL ACCESSORIES

ITEM	KL165B	KA90..A	KA90..B
C Silencer kit	615 396 117 0		
D Silencer kit	615 399 462 0		
5 Complete silencer kit		615 396 166 0	
6 Inlet hose assembly L = 1.7 m (67") 3/8"M - 3/8"F ø 10 mm		615 870 210 0	
7 Reinforced cloth-lined exhaust hose L = 0.75 m (30")		615 875 116 0	
8 Vibration-damping side handle		615 576 066 0	

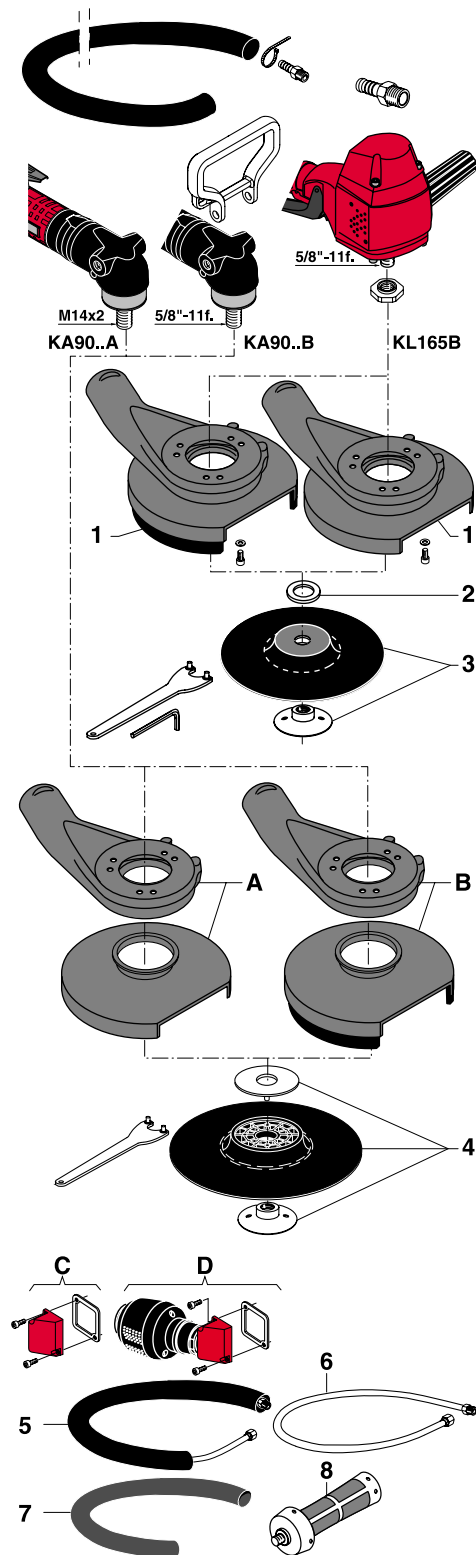

# Dust extraction systems for vertical and angle sanders ø 180 mm (7")

900 - 1 200 Watts (1.21 - 1.61 hp) - 2 000 to 6 500 rpm

**Supplied with M14 or 5/8" threaded spindle only**



A



B

For standard abrasive disc for non metallic materials

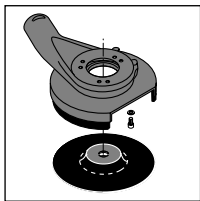

615 399 364 0

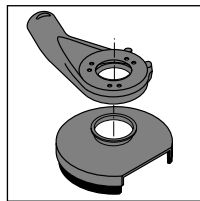

615 396 126 0

For standard abrasive disc for metallic materials

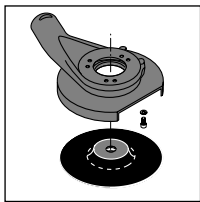

615 399 365 0

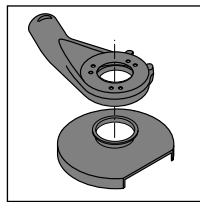

615 396 125 0

Vacuum hose, ID 38 mm (1-1/2")



B

Caution: comply with the speeds recommended by component and abrasive manufacturers

PICTURE REF	MODEL	PART NUMBER	DUST EXTRACTION KIT	FREE	THREADED	POWER		WEIGHT		
				SPEED	SPINDLE	W	hp	kg	lb.	
				rpm						
<b>VERTICAL SANDER</b>										
A	KL165B	615 170 011 0 +	615 399 364 0 or 615 399 365 0	6500	5/8"-11f.	1200	1.61	2.3	5.1	
<b>ANGLE SANDERS</b>										
B	KA9030A	615 170 098 0 +	615 396 126 0 or 615 396 125 0	3000	M14x2	900	1.21	1.6	3.5	
B	KA9030B	615 170 099 0 +	615 396 126 0 or 615 396 125 0	3000	5/8"-11f.	900	1.21	1.6	3.5	
B	KA9020A	615 170 096 0 +	615 396 126 0 or 615 396 125 0	2000	M14x2	900	1.21	1.6	3.5	
B	KA9020B	615 170 097 0 +	615 396 126 0 or 615 396 125 0	2000	5/8"-11f.	900	1.21	1.6	3.5	