

# Accessories

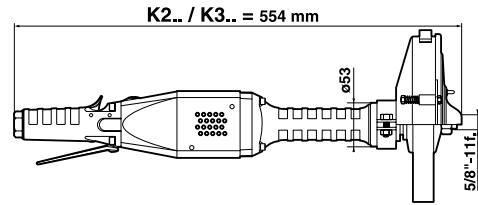

## K190B3CW - ø 80 mm (3")

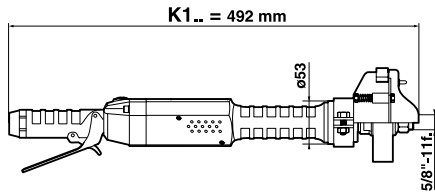
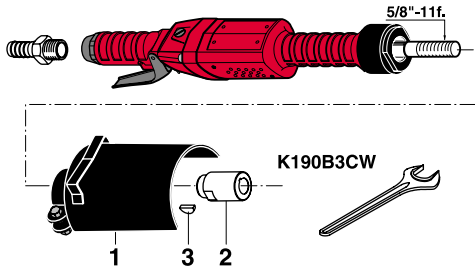

### ACCESSORIES INCLUDED

ITEM	PART NO.
• 1/2" air hose nipple for 15 mm ID hose	615 704 014 0
1 Wheel guard	615 504 080 0
2 Rear flange	615 503 095 0
3 Woodruff key	615 630 019 0
• Flat wrench, 27 mm (1-1/16")	615 801 077 0

## K190B4 / K160B6 / K145B6 / K260B6 / K360B6

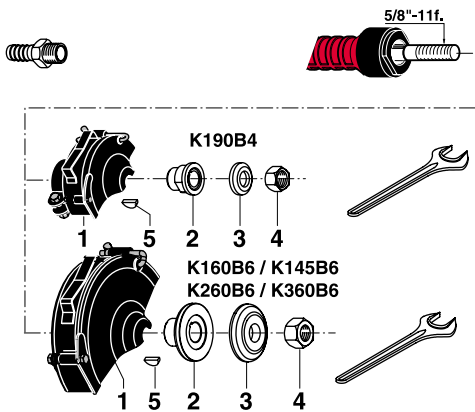

### ACCESSORIES INCLUDED

ITEM	K190B4 ø 100 mm (4")	K1..B6 K260B6 K360B6 ø 150 mm (6")
	• 1/2" air hose nipple for 15 mm ID hose	615 704 014 0
1 Wheel guard	615 504 154 0	615 504 079 0
2 Rear flange	615 503 094 0	615 503 028 0
3 Front flange	615 502 046 0	615 502 027 0
4 Nut	615 608 006 0	615 608 006 0
5 Woodruff key	615 630 019 0	615 630 019 0
• Flat wrench, 27 mm (1-1/16")	615 801 077 0	615 801 077 0

## K245B8 / K345B8 - ø 200 mm (8")

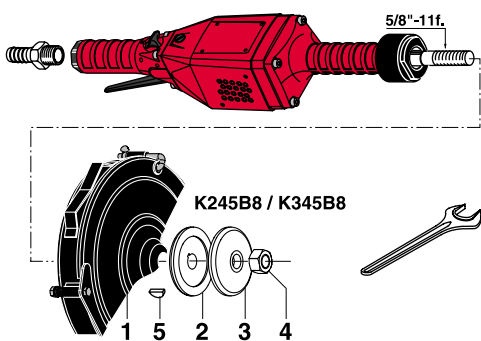

### ACCESSORIES INCLUDED

ITEM	K245B8 K345B8 ø 200 mm (8")
• 1/2" air hose nipple for 15 mm ID hose	615 704 014 0
1 Wheel guard	615 504 078 0
2 Rear flange	615 503 004 0
3 Front flange	615 502 007 0
4 Nut	615 608 006 0
5 Woodruff key	615 630 019 0
• Flat wrench, 27 mm (1-1/16")	615 801 077 0

### OPTIONAL ACCESSORIES

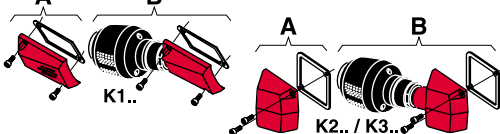

ITEM	K1..	K2.. / K3..
A Silencer kit	615 399 298 0	615 399 227 0
B Silencer kit	615 399 459 0	615 399 460 0



# Grinders for cone wheels and type 1 wheels

∅ 80 mm (3") - ∅ 100 mm (4") - ∅ 150 mm (6")  
- ∅ 200 mm (8")

1 000 to 2 700 Watts (1.34 to 3.62 hp) - 4 500 to 9 000 rpm

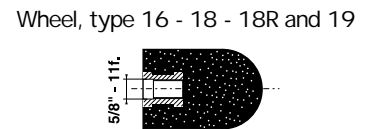
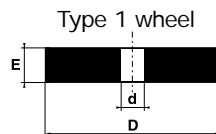
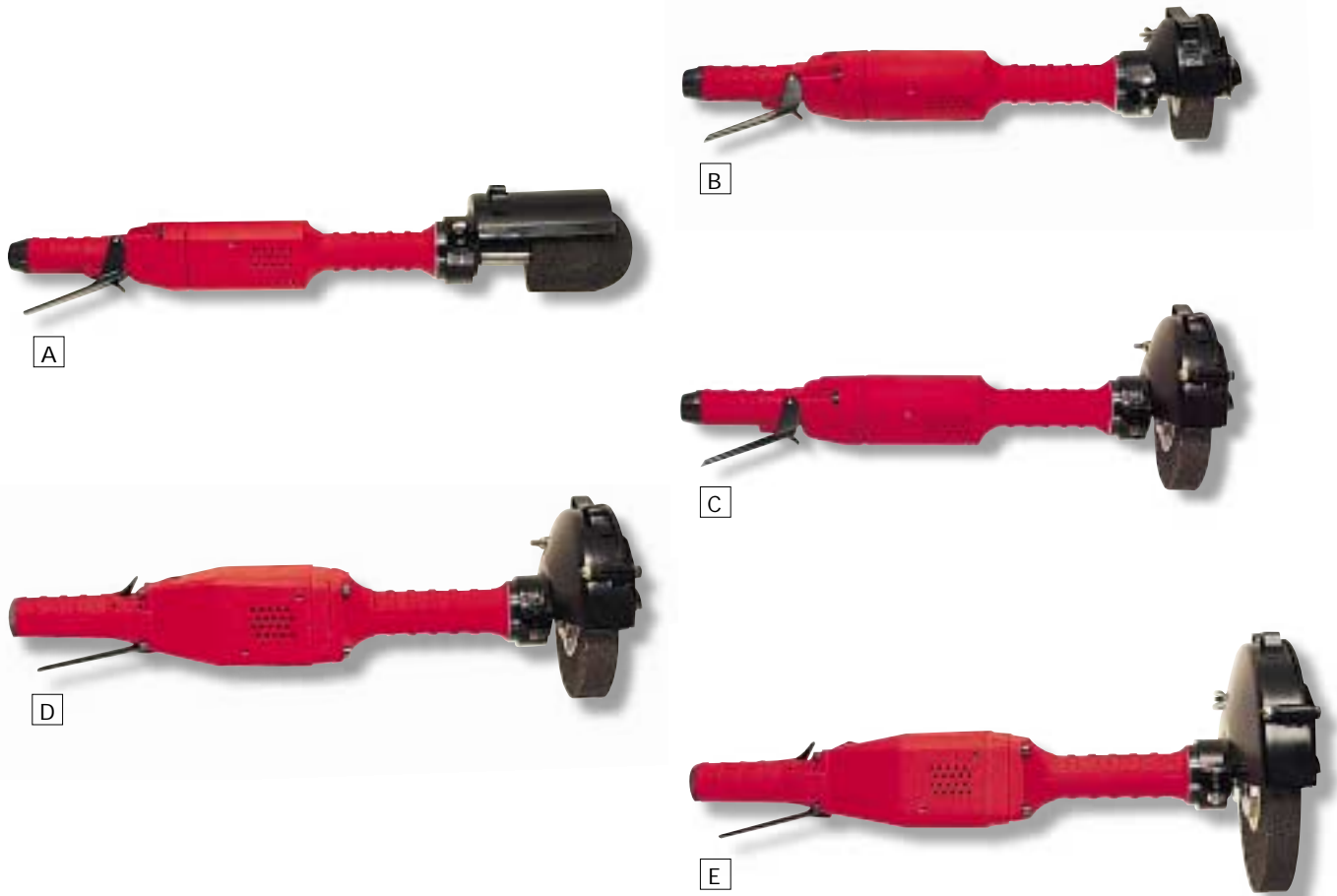

Caution: comply with the speeds recommended by component and abrasive manufacturers

PICTURE REF	MODEL	PART NUMBER	FREE	WHEEL MAX CAPACITY DxExd		THREADED	POWER		WEIGHT		AIR CONSUMPTION				AIR	HOSE
			SPEED	mm	inch	SPINDLE	W	hp	kg	lb.	l/s	cfm	l/s	cfm	INLET THREAD	INT. Ø
			rpm			inch								inch	mm	
A	K190B3CW	615 170 005 0	9000	80	3	5/8-11f.	1 200	1.61	3.5	7.7	9	19	27	57	1/2	15
B	K190B4	615 170 004 0	9000	100x25x15.9	4x1x5/8	5/8-11f.	1 200	1.61	3.2	7.0	9	19	27	57	1/2	15
C	K160B6	615 170 003 0	6000	150x25x15.9	6x1x5/8	5/8-11f.	1 200	1.61	3.5	7.7	6	12	23	48	1/2	15
C	K145B6	615 170 002 0	4500	150x25x15.9	6x1x5/8	5/8-11f.	1 000	1.34	3.5	7.7	5	10	20	42	1/2	15
D	K260B6	615 170 008 0	6000	150x25x15.9	6x1x5/8	5/8-11f.	2 000	2.70	5.1	11.2	10	21	38	80	1/2	15
D	K360B6	615 170 010 0	6000	150x25x15.9	6x1x5/8	5/8-11f.	2 700	3.62	5.6	12.3	13	27	41	86	1/2	15
E	K245B8	615 170 006 0	4500	200x25x15.9	8x1x5/8	5/8-11f.	1 800	2.41	5.8	12.7	8	17	32	67	1/2	15
E	K345B8	615 170 009 0	4500	200x25x15.9	8x1x5/8	5/8-11f.	2 400	3.22	6.3	13.9	8	17	33	70	1/2	15

# Accessories

KA11120A5F / KA11120B5F = 221 mm

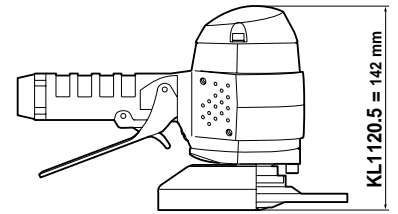
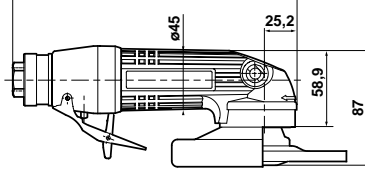

## KA11120A5F / KA11120B5F - ø 127 mm (5")

### ACCESSORIES INCLUDED

ITEM	KA11120A5F M14x2	KA11120B5F 5/8"-11f.
• Exhaust hose L = 1.5 m (60")	615 875 1130	615 875 1130
• Clamp	615 875 415 0	615 873 415 0
• 3/8" air hose nipple for 13 mm ID hose	615 704 027 0	615 704 027 0
• Side handle	615 576 038 0	615 576 038 0
1 Wheel guard	615 504 142 0	615 504 142 0
2 Rear flange	615 503 134 0	615 503 141 0
3 Front flange	615 502 066 0	615 502 067 0
4 Safety screw	615 614 076 0	615 614 076 0
• Pin wrench, 35 mm (1-3/8")	615 802 010 0	615 802 010 0
• Flat wrench, 24 mm (15/16")	615 801 075 0	615 801 075 0
• Hex. key 6.35 mm (1/4")	615 802 057 0	615 802 057 0

### OPTIONAL ACCESSORIES

ITEM	PART NO.
5 Complete silencer kit	615 396 166 0
6 Inlet hose assembly L = 1.7 m (67") 3/8"M - 3/8"F ø 13 mm	615 804 064 0
7 Reinforced cloth-lined exhaust hose L = 0.75 m (30")	615 875 116 0
8 Vibration-damping side handle	615 576 066 0
9 Thermal insulating sleeve	615 570 412 0
10 Grease gun (capacity 24 g.)	615 990 149 0
• Lubricant for bevel gear (1 kg)	615 990 148 0

## KL1120A5 / KL1120B5 - ø 127 mm (5")

### ACCESSORIES INCLUDED

ITEM	KL1120A5 M14x2	KL1120B5 5/8"-11f.
• 3/8" air hose nipple for 10 mm ID hose	615 704 017 0	615 704 017 0
1 Wheel guard	615 504 086 0	615 504 086 0
2 Rear flange	615 503 096 0	615 503 143 0
3 Washer for wheels thickness <2 mm	615 642 052 0	-
4 Nut	615 606 032 0	615 502 067 0
5 Safety screw	615 614 033 0	615 614 076 0
• Pin wrench, 35 mm (1-3/8")	615 802 010 0	615 802 010 0
• Flat wrench, 27 mm (1-1/16")	615 801 077 0	615 801 077 0
• Hex. key 6 mm	615 802 056 0	-
• Hex. key 6.35 mm (1/4")	-	615 802 057 0

### OPTIONAL ACCESSORIES

ITEM	PART NO.
A Silencer kit	615 396 117 0
B Silencer kit	615 399 462 0

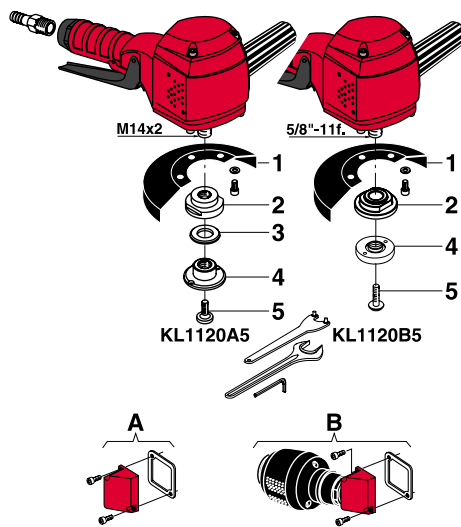
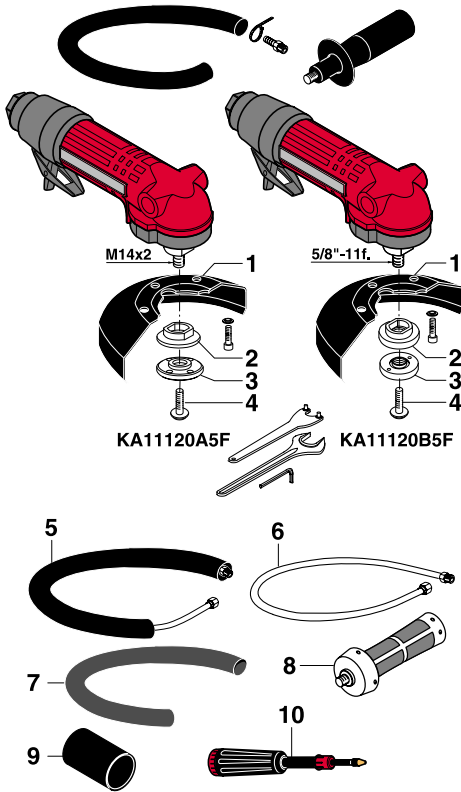

# Grinders for depressed centre wheels, cut-off wheels and flap wheels Ø 127 mm (5")

750 - 1100 Watts (1.02 - 1.5 hp) - 12 000 rpm

**Fixed wheel guard**



Adjustable lever

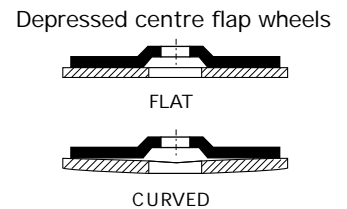
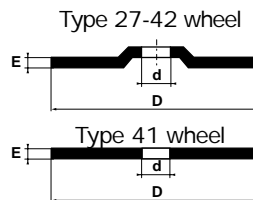

Caution: comply with the speeds recommended by component and abrasive manufacturers

PICTURE REF	MODEL	PART NUMBER	FREE SPEED	WHEEL MAX CAPACITY DxD		THREADED SPINDLE	POWER		WEIGHT		AIR CONSUMPTION				AIR INLET THREAD	HOSE INT. Ø
				mm	inch		W	hp	kg	lb.	l/s	cfm	l/s	cfm		
A	KA11120A5F	615 170 052 0	12000	127x6.4x22.2	5x1/4x7/8	M14x2	1100	1.5	1.7	3.7	10	21	20	42	3/8	13
A	KA11120B5F	615 170 055 0	12000	127x6.4x22.2	5x1/4x7/8	5/8"-11f.	1100	1.5	1.7	3.7	10	21	20	42	3/8	13
B	KL1120A5	615 170 013 0	12000	127x6.4x22.2	5x1/4x7/8	M14x2	750	1.02	2.3	5.0	16	34	16	34	3/8	10
B	KL1120B5	615 170 181 0	12000	127x6.4x22.2	5x1/4x7/8	5/8"-11f.	750	1.02	2.3	5.0	16	34	16	34	3/8	10

# Accessoires

KA11120H5K / KA11120A5K = 221 mm

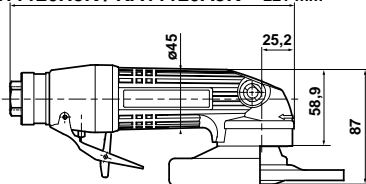

KA11120A5 / KA11120B5 = 221 mm

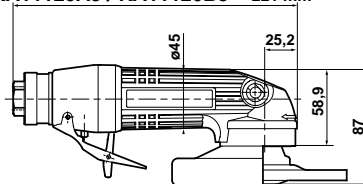

## KA11120H5K / KA11120A5K - ø 127 mm (5")

### ACCESSOIRES LIVRÉS AVEC L'OUTIL

REP.	KA11120H5K Hex.	KA11120A5K M14x2
• Kit silencieux complet	615 396 166 0	615 396 166 0
• Poignée latérale antivibratile	615 576 066 0	615 576 066 0
• Manchon d'isolation thermique	615 570 412 0	615 570 412 0
• Coffret	-	-
1 Protecteur orientable	615 504 163 0	615 504 163 0
2 Flasque arrière	615 503 124 0	615 503 134 0
3 Flasque avant	615 502 062 0	615 502 066 0
4 Vis de sécurité	615 616 101 0	615 614 076 0
• Clé à ergots entraxe 35 mm (1-3/8")	-	615 802 010 0
• Clé Hex. 6 mm	615 802 056 0	-
• Clé Hex. 6,35 mm (1/4")	-	615 802 057 0

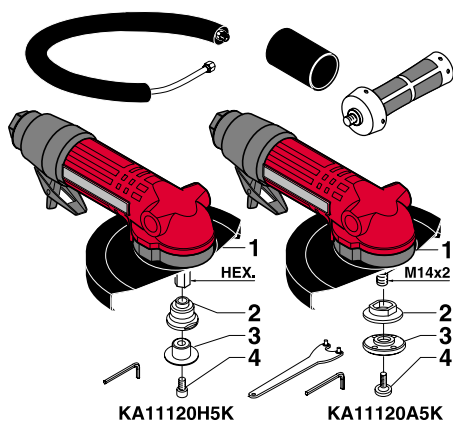

## KA11120A5 / KA11120B5 - ø 127 mm (5")

### ACCESSOIRES LIVRÉS AVEC L'OUTIL

REP.	KA11120A5 M14x2	KA11120B5 5/8"-11f.
• Gaine d'échappement L = 1,5 m (60")	615 875 113 0	615 875 113 0
• Collier	615 873 415 0	615 873 415 0
• Busette 3/8" pour tuyau ø int. 13 mm	615 704 027 0	615 704 027 0
• Poignée latérale	615 576 038 0	615 576 038 0
1 Protecteur orientable	615 504 163 0	615 504 163 0
2 Flasque arrière	615 503 134 0	615 503 141 0
3 Flasque avant	615 502 066 0	615 502 067 0
4 Vis de sécurité	615 614 076 0	615 614 076 0
• Clé à ergots entraxe 35 mm (1-3/8")	615 802 010 0	615 802 010 0
• Clé Hex. 6,35 mm (1/4")	615 802 057 0	615 802 057 0

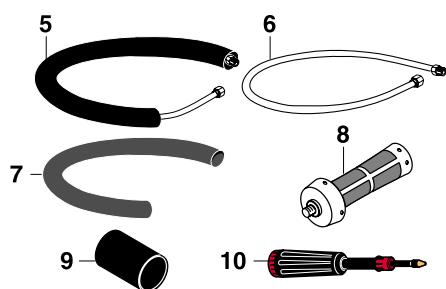
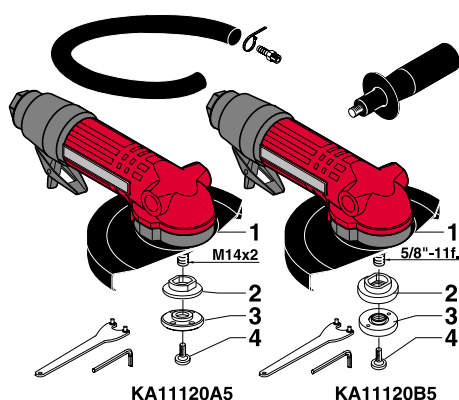

### ACCESSOIRES EN OPTION

REP.	RÉFÉRENCE
5 Kit silencieux complet	615 396 166 0
6 Tuyau d'admission complet L = 1,7 m (67") 3/8"M - 3/8"F - ø 13 mm	615 804 064 0
7 Gaine d'échappement toilée renforcée L = 0,75 m (30")	615 875 116 0
8 Poignée latérale antivibratile	615 576 066 0
9 Manchon d'isolation thermique	615 570 412 0
10 Pompe à graisse (avec 24 gr. de graisse)	615 990 149 0
• Graisse pour couple conique (contenance 1 kg)	615 990 148 0





# Meuleuses pour meules à moyeu déporté, disques à tronçonner et disques à lamelles Ø 127 mm (5")

1100 Watts (1.5 hp) - 12 000 tr/min.

**Montage rapide de meule - Protecteur orientable**



A



B

Levier orientable

Protecteur orientable sans outil par simple pression et orientation manuelle.



Bouton de blocage et arbre hexagonal permettant le montage de meule avec une seule clé 6 pans.

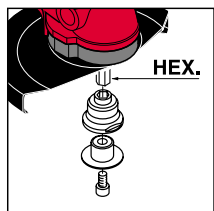

HEX.



Bouton de blocage



Meule type 27-42

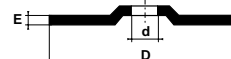

Meule type 41

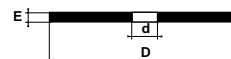

Disques à lamelles  
à moyeu déporté



PLAT



BOMBÉ

**Attention : Respecter les vitesses préconisées par les fabricants d'accessoires et d'abrasifs**

REP. PHOTOS	MODÈLE	RÉFÉRENCE COMMANDE	VITESSE À VIDE	CAPACITÉ MAXI MEULE		ARBRE FILETÉ	PUISSANCE		CONSOMMATION				FILETAGE ENTRÉE D'AIR	Ø INT. TUYAU		
				D	xExd		W	hp	À VIDE	EN CHARGE	l/s	cfm			l/s	cfm
A	KA11120H5K	615 170 028 0	12 000	127x6.4x22.2	5x1/4x7/8	HEX	1100	1.5	1,7	3,7	10	21	20	42	3/8	13
A	KA11120A5K	615 170 054 0	12 000	127x6.4x22.2	5x1/4x7/8	M14x2	1100	1.5	1,7	3,7	10	21	20	42	3/8	13
B	KA11120A5	615 170 053 0	12 000	127x6.4x22.2	5x1/4x7/8	M14x2	1100	1.5	1,7	3,7	10	21	20	42	3/8	13
B	KA11120B5	615 170 056 0	12 000	127x6.4x22.2	5x1/4x7/8	5/8"-11f.	1100	1.5	1,7	3,7	10	21	20	42	3/8	13

# Accessories

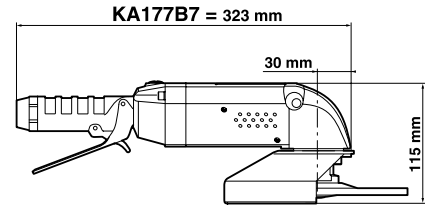
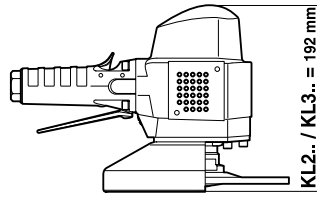
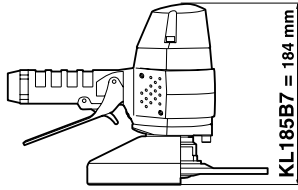

## KL185B7 / KL285B7 / KL377B7 / KA177B7

### ACCESSORIES INCLUDED

ITEM	KL185B7	KL285B7	KA177B7
	ø 180 mm (7")	ø 180 mm (7")	ø 180 mm (7")
• Vibration-damping side handle	-	-	615 576 066 0
• 1/2" air hose nipple for 15 mm ID hose	-	615 704 014 0	615 704 014 0
• 1/2" air hose nipple for 13 mm ID hose	615 704 016 0	-	-
1 Wheel guard	615 504 095 0	615 504 128 0	615 504 133 0
2 Rear flange	615 503 103 0	615 503 103 0	615 503 103 0
3 Nut	615 542 104 0	615 542 104 0	615 542 104 0
4 Safety screw	615 614 034 0	615 614 034 0	615 614 034 0
• Pin wrench, 35 mm (1-3/8")	615 802 010 0	615 802 010 0	615 802 010 0
• Flat wrench, 27 mm (1-1/16")	615 801 077 0	615 801 077 0	615 801 077 0
• Hex. key 6 mm	615 802 056 0	615 802 056 0	615 802 056 0

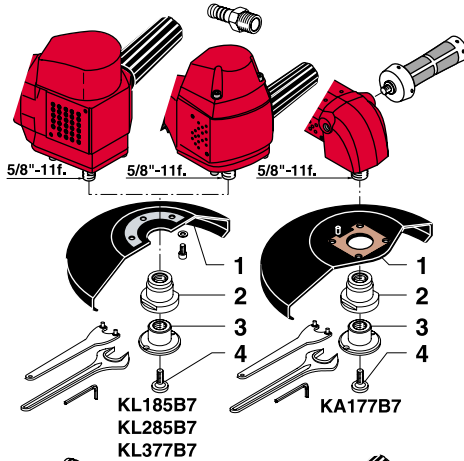

## KL260B6C / KL360B6C - ø 150 mm (6")

### ACCESSORIES INCLUDED

ITEM	PART NO.
• 1/2" air hose nipple for 15 mm ID hose	615 704 014 0
1 Wheel guard	615 399 010 0
2 Rear flange	615 503 116 0
3 Safety screw	615 614 034 0
• Flat wrench, 27 mm (1-1/16")	615 801 077 0
• Hex. key 6 mm	615 802 056 0

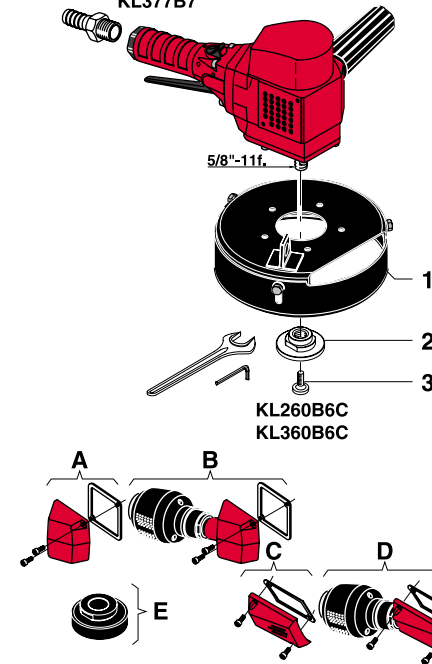

### OPTIONAL ACCESSORIES

ITEM	KL2../ KL3..	KL185B7	KA177B7
A Silencer kit	615 399 227 0	615 396 117 0	-
B Silencer kit	615 399 460 0	615 399 462 0	-
C Silencer kit	-	-	615 399 298 0
D Silencer kit	-	-	615 399 459 0
E Vibration reducer (except KL260/360B6C)	615 503 146 0	615 503 146 0	615 503 146 0



# Grinders for depressed centre wheels, cup wheels and flap wheels Ø 150 mm (6") - Ø 180 mm (7")

1 200 to 2 800 Watts (1.61 to 3.75 hp) - 6 000 to 8 500 rpm



Type 27-42 wheel

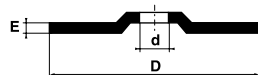

Type 41 wheel

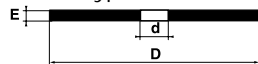

Depressed centre flap wheels

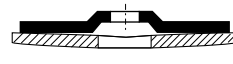
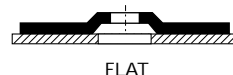

TYPE 6 wheel

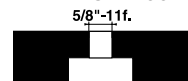

TYPE 11 wheel

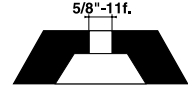

Caution: comply with the speeds recommended by component and abrasive manufacturers

PICTURE REF	MODEL	PART NUMBER	FREE SPEED	WHEEL MAX CAPACITY DxD		THREADED SPINDLE	POWER		WEIGHT		AIR CONSUMPTION				AIR INLET THREAD	HOSE INT. Ø
				mm	inch		W	hp	kg	lb.	l/s	cfm	l/s	cfm		
<b>VERTICAL GRINDERS</b>																
A	KL185B7	615 1700120	8500	180x9.5x22.2	7x3/8x7/8	5/8-11f.	1200	1.61	28	6.1	16	34	27	57	1/2	13
B	KL285B7	615 1700170	8500	180x9.5x22.2	7x3/8x7/8	5/8-11f.	2500	3.35	4.0	8.8	15	31	44	93	1/2	15
B	KL377B7	615 1702020	7700	180x9.5x22.2	7x3/8x7/8	5/8-11f.	2800	3.75	4.2	9.2	19	40	46	97	1/2	15
<b>ANGLE GRINDER</b>																
C	KA177B7	615 1700210	7700	180x9.5x22.2	7x3/8x7/8	5/8-11f.	1200	1.61	2.9	6.3	14	30	27	57	1/2	15
<b>VERTICAL GRINDERS for cup wheels</b>																
D	KL260B6C	615 1700150	6000	150	6	5/8-11f.	2200	3.00	4.2	9.2	9	19	39	82	1/2	15
D	KL360B6C	615 1700180	6000	150	6	5/8-11f.	2700	3.62	4.4	9.7	12	25	43	91	1/2	15



# Accessoires

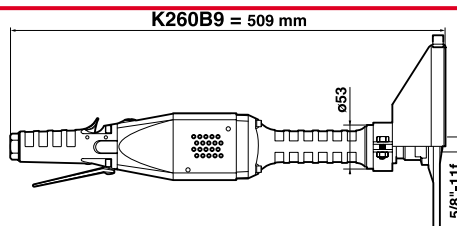
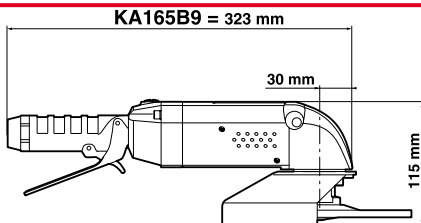
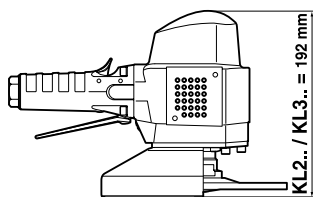

## KL265B9 / KL365B9 / KA165B9 - ø 230 mm (9")

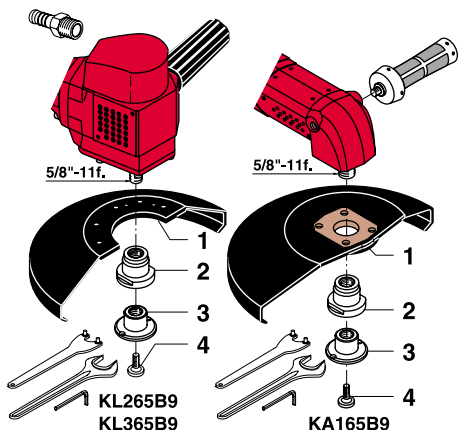

### ACCESSOIRES LIVRÉS AVEC L'OUTIL

REP.	KL265B9 KL365B9	KA165B9
• Poignée latérale antivibratile	-	615 576 066 0
• Busette 1/2" pour tuyau ø int. 15 mm	615 704 014 0	615 704 014 0
1 Protecteur	615 504 127 0	615 504 136 0
2 Flasque arrière	615 503 103 0	615 503 103 0
3 Écrou	615 542 104 0	615 542 104 0
4 Vis de sécurité	615 614 034 0	615 614 034 0
• Clé à ergots entraxe 35 mm (1-3/8")	615 802 010 0	615 802 010 0
• Clé plate 27 mm (1-1/16")	615 801 077 0	615 801 077 0
• Clé Hex. 6 mm	615 802 056 0	615 802 056 0

## K260B9 - ø 230 mm (9")

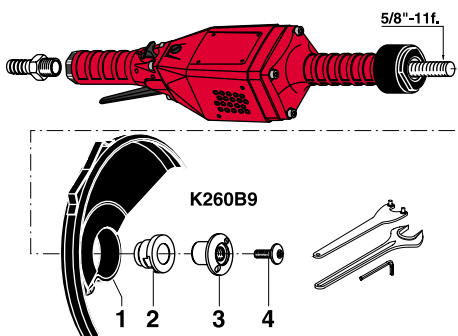

### ACCESSOIRES LIVRÉS AVEC L'OUTIL

REP.	RÉFÉRENCE
• Busette 1/2" pour tuyau ø int. 15 mm	615 704 014 0
1 Protecteur	615 504 161 0
2 Flasque arrière	615 503 103 0
3 Écrou	615 542 104 0
4 Vis de sécurité	615 614 034 0
• Clé à ergots entraxe 35 mm (1-3/8")	615 802 010 0
• Clé plate 27 mm (1-1/16")	615 801 077 0
• Clé Hex. 6 mm	615 802 056 0

### ACCESSOIRES EN OPTION

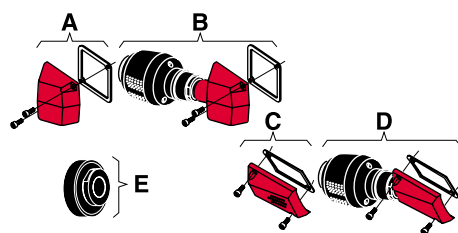

REP.	KL265B9 KL365B9	K260B9	KA165B9
A Équipement silencieux	615 399 227 0	-	-
B Équipement silencieux	615 399 460 0	-	-
C Équipement silencieux	-	615 399 298 0	-
D Équipement silencieux	-	615 399 459 0	-
E Réducteur de vibrations	615 503 146 0	615 503 146 0	-



# Meuleuses pour meules à moyeu déporté

## Ø 230 mm (9")

1 200 à 2 700 Watts (1.61 à 3.62 hp) - 6 000 - 6 500 tr/min.



A



B



C

Meule type 27-42

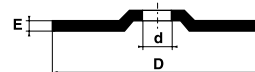

Meule type 41

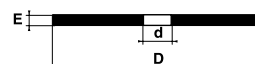

**Attention : Respecter les vitesses préconisées par les fabricants d'accessoires et d'abrasifs**

REP.	MODÈLE	RÉFÉRENCE	VITESSE	CAPACITÉ		ARBRE	PUISSANCE		MASSE		CONSOMMATION				FILETAGE	Ø
				MAXI MEULE	À VIDE		ENTRÉE	INT.	À	EN	ENTRÉE	INT.	TUYAU			
PHOTOS		COMMANDE	À VIDE	mm	inch	FILETÉ	W	hp	kg	lb.	l/s	cfm	l/s	cfm	inch	mm
<b>MEULEUSES VERTICALES</b>																
A	KL265B9	615 170 016 0	6 500	230x6,4x22,2	9x1/4x7/8	5/8-11f.	2 200	3.00	4,2	9.2	10	21	40	84	1/2	15
A	KL365B9	615 170 019 0	6 500	230x6,4x22,2	9x1/4x7/8	5/8-11f.	2 700	3.62	4,4	9.7	13	27	44	93	1/2	15
<b>MEULEUSE D'ANGLE</b>																
B	KA165B9	615 170 020 0	6 500	230x6,4x22,2	9x1/4x7/8	5/8-11f.	1 200	1.61	3,0	6.6	11	23	25	53	1/2	15
<b>MEULEUSE DROITE</b>																
C	K260B9	615 170 007 0	6 000	230x6,4x22,2	9x1/4x7/8	5/8-11f.	2 000	2.70	5,0	11.0	10	21	38	80	1/2	15

# Abrasive accessories

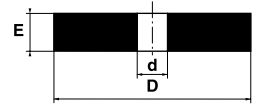

FLAT WHEELS, TYPE 01

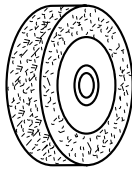

SPEED MAX rpm	D mm	E mm	d mm	PART NO.
15 000	63	12.7	9.5	615 840 060 0
12 000	80	20	12.7	615 840 081 0
9 500	100	25	15.8	615 840 100 0
6 400	150	25	15.8	615 840 150 0

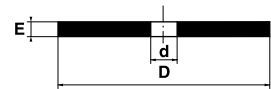

FLAT WHEELS, TYPE 41 (1R)

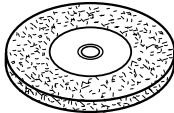

SPEED MAX rpm	D mm	E mm	d mm	PART NO.
20 000	76	1.8	9.5	615 842 081 0
20 000	76	6.4	9.5	615 842 085 0
10 000	150	25.0	25.0	615 842 150 0



CONE WHEELS, TYPE 18 R

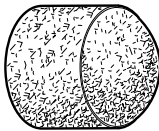

SPEED MAX rpm	D mm	d inch	PART NO.
15 000	63	5/8-11f.	615 840 063 0
12 000	76	5/8-11f.	615 840 083 0

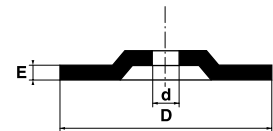

DEPRESSED CENTRE WHEELS, TYPE 27 and 42\*

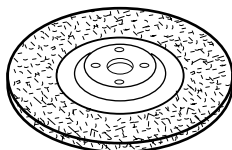

SPEED MAX rpm	D mm	E mm	d mm	PART NO.
20 000	76	25	10.0	615 841 006 0*
20 000	76	7.0	10.0	615 841 003 0
15 000	100	3.2	15.8	615 841 103 0
15 000	100	6.4	15.8	615 841 106 0
12 000	127	1.8	22.2	915 842 127 0
12 000	127	3.2	22.2	615 841 123 0
12 000	127	4.8	22.2	615 841 125 0
12 000	127	6.4	22.2	615 841 126 0

