

Accessories

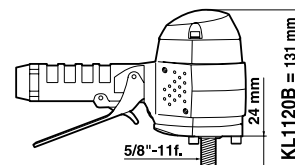
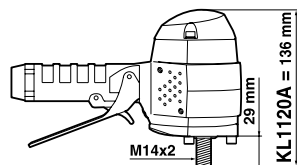

KL1120A / KL1120B

ACCESSORIES INCLUDED

	PART NO.
• 3/8" air hose nipple for 10 mm ID hose	615 704 017 0

OPTIONAL ACCESSORIES

Sanding with standard abrasive disc ø 127 mm (5")	KL11120A	KL11120B
ITEM	M14x2	5/8"-11f.
A Sanding kit for abrasive disc (including Item 1)	615 399 251 0	615 399 251 0
1 Ventilated backing pad with nut M14 and 5/8" (max: 12000 rpm)	615 990 127 0	615 990 127 0
• Pin wrench, 35 mm (1-3/8")	615 802 010 0	615 802 010 0
• Hex. key 8 mm (5/16")	615 802 061 0	615 802 061 0

Sanding with semirigid disc ø127 mm (5")	KA1120A
ITEM	M14x2
2 Wheel guard	615 504 086 0
B Sanding kit for semirigid disc (including Item 3)	615 399 203 0
3 Backing pad with nut M14 (max: 12 000 rpm)	615 990 129 0
• Pin wrench, 35 mm (1-3/8")	615 802 010 0
• Hex. key 8 mm (5/16")	615 802 061 0

OTHER OPTIONAL ACCESSORIES

ITEM	PART NO.
4 Semi-hard backing pad with nut M14 and 5/8" (max: 12 000 rpm)	615 804 074 0
C Silencer kit	615 396 117 0
D Silencer kit	615 399 462 0

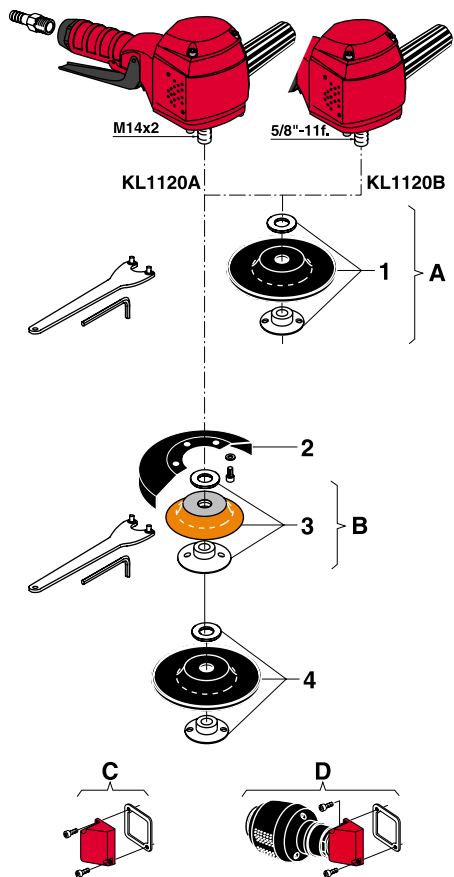

Lou Zampini & Associates

2 Douglas Pike, Rt. 7
Smithfield, RI 02917
1 800 353 4676
FAX 1 401 679 0165



Sanders for abrasive discs

Ø 127 mm (5")

750 Watts (1.02 hp) - 12 000 rpm

Supplied with M14 or 5/8" threaded spindle only



A



Caution: comply with the speeds recommended by component and abrasive manufacturers

PICTURE REF	MODEL	PART NUMBER	FREE SPEED rpm	ABRASIVE MAX CAPACITY		THREADED SPINDLE	POWER		WEIGHT		AIR CONSUMPTION AT FREE SPEED		AIR INLET THREAD inch	HOSE INT. Ø mm
				mm	inch		W	hp	kg	lb.	l/s	cfm		
A	KL1120A	615 170 022 0	12000	Ø127	5	M14x2	750	1.02	2.2	4.8	16	34	3/8	10
A	KL1120B	615 170 207 0	12000	Ø127	5	5/8"-11f.	750	1.02	2.2	4.8	16	34	3/8	10

Accessories

KA11120A / KA11075A / KA11060A = 221 mm

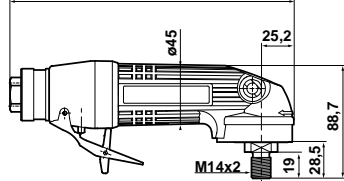

KA11075B / KA11060B = 221 mm

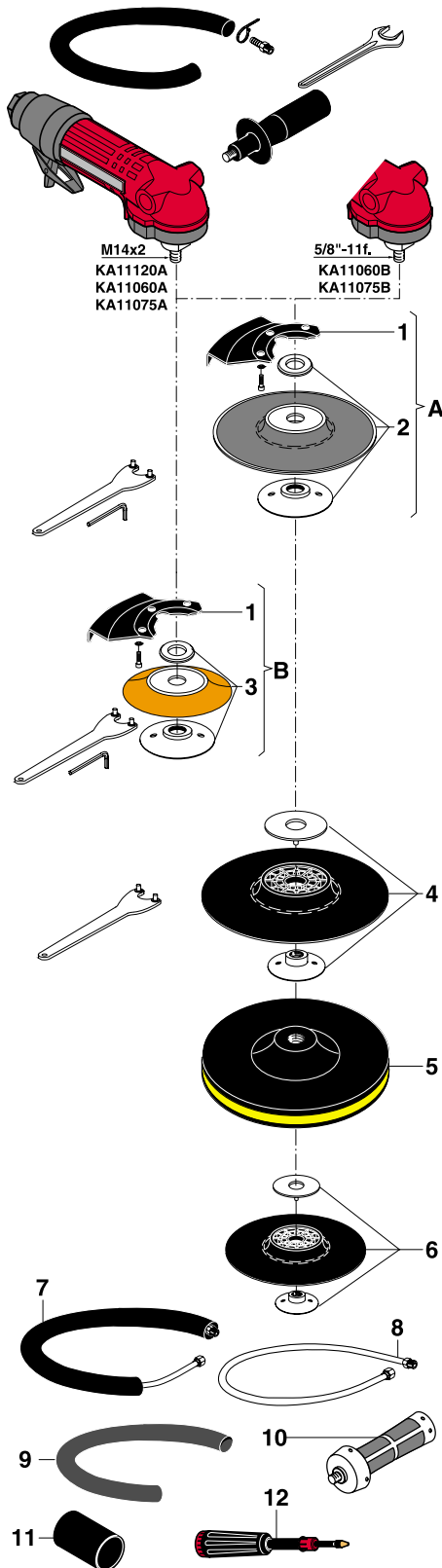
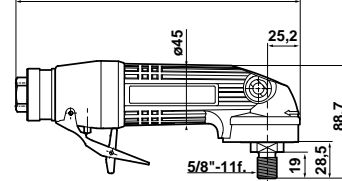

KA11120A / KA11075A / KA11075B / KA11060A / KA11060B

ACCESSORIES INCLUDED

	PART NO.
• Exhaust hose L = 1.5 m (60")	615 875 1130
• Clamp	615 873 4150
• 3/8" air hose nipple for 13 mm ID hose	615 704 0270
• Side handle	615 576 0380
• Flat wrench, 17 mm (11/16")	615 801 0320

OPTIONAL ACCESSORIES

Sanding with standard abrasive disc ø 127 mm (5")		PART NO.
ITEM		
A Sanding kit for abrasive disc (including Items 1-2)		615 396 0720
1 Finger guard		615 504 1450
2 Ventilated backing pad with nut M14 and 5/8" (max: 12 000 rpm)		615 990 1270
• Pin wrench, 35 mm (1-3/8")		615 802 0100
• Hex. key 8 mm (5/16")		615 802 0610

Sanding with semirigid disc ø 127 mm (5")		KA11120A	KA11060/75A
ITEM			
B Sanding kit for semirigid disc (including Item 1-3)		615 396 0750	
1 Finger guard		615 504 1450	
3 Backing pad with nut M14 (max: 12 000 rpm)		615 990 1290	
• Pin wrench, 35 mm (1-3/8")		615 802 0100	
• Hex. key 8 mm (5/16")		615 802 0610	

Sanding ITEM	KA11075/60A M14x2	KA11075/60B 5/8"-11f.
4 Soft backing pad with nut M14 and 5/8" ø 180 mm (7") (max: 8 500 rpm)	615 990 1330	615 990 1330
4 Rigid backing pad with nut M14 and 5/8" ø 180 mm (7") (max: 8 500 rpm)	615 990 1340	615 990 1340
• Pin wrench, 35 mm (1-3/8")	615 802 0100	615 802 0100
5 Rigid velcro-backed backing pad ø 180 mm (7") (max: 8 700 rpm)	615 990 1450	615 990 1460
5 Rigid velcro-backed backing pad ø 150 mm (6") (max: 10 000 rpm)	615 990 1370	615 990 1380

OTHER OPTIONAL ACCESSORIES

ITEM	PART NO.
6 Semi-hard backing pad ø 127 mm (5") with nut M14 and 5/8" (max: 12 000 rpm)	615 804 0740
7 Complete silencer kit	615 396 1660
8 Inlet hose assembly L = 1.7 m (67") 3/8"M - 3/8"F ø 13 mm	615 804 0640
9 Reinforced cloth-lined exhaust hose L = 0.75 m (30")	615 875 1160
10 Vibration-damping side handle	615 576 0660
11 Thermal insulating sleeve	615 570 4120
12 Grease gun (capacity 24 g.)	615 990 1490
• Lubricant for bevel gear (1 kg)	615 990 1480

Sanders for abrasive discs

∅ 127 mm (5") - ∅ 150 mm (6") - ∅ 180 mm (7")

900 to 1 100 W (1.21 to 1.5 hp) - 6 000 to 12 000 rpm

Supplied with M14 or 5/8" threaded spindle only



A



A



B



Caution: comply with the speeds recommended by component and abrasive manufacturers

PICTURE REF	MODEL	PART NUMBER	FREE	THREADED	POWER		WEIGHT		AIR CONSUMPTION				AIR	HOSE
			SPEED	SPINDLE	W	hp	kg	lb.	AT FREE SPEED	AT MAX OUTPUT	INLET THREAD	INT. ∅		
			rpm						l/s	cfm	l/s	cfm	inch	mm
A	KA11120A	615 170 051 0	12000	M14x2	1100	1.50	1.4	3.1	10	21	20	42	3/8	13
B	KA11075A	615 170 061 0	7500	M14x2	1000	1.34	1.4	3.1	7	15	19	40	3/8	13
B	KA11075B	615 170 062 0	7500	5/8"-11f.	1000	1.34	1.4	3.1	7	15	19	40	3/8	13
B	KA11060A	615 170 063 0	6000	M14x2	900	1.21	1.4	3.1	6	13	17	36	3/8	13
B	KA11060B	615 170 064 0	6000	5/8"-11f.	900	1.21	1.4	3.1	6	13	17	36	3/8	13

Accessories

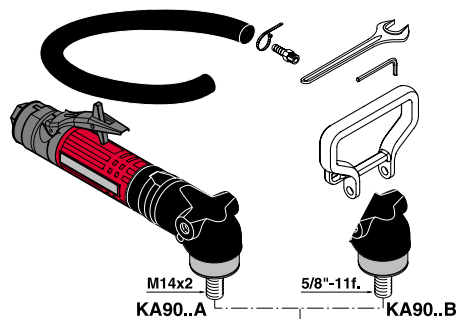
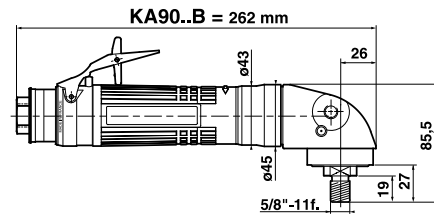
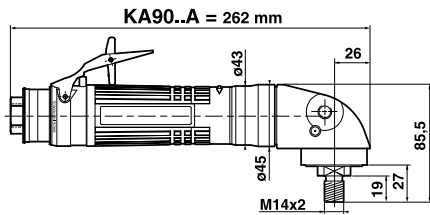

KA90..A KA90..B

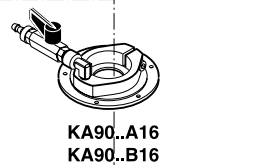

KA90..A16
KA90..B16

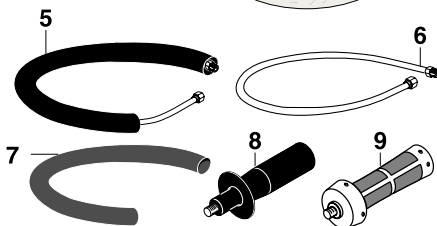
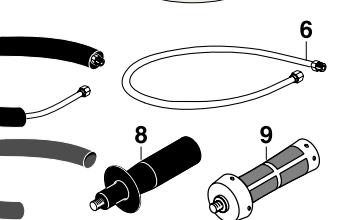
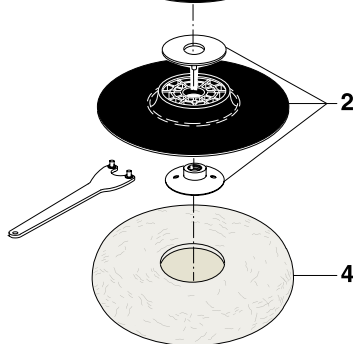
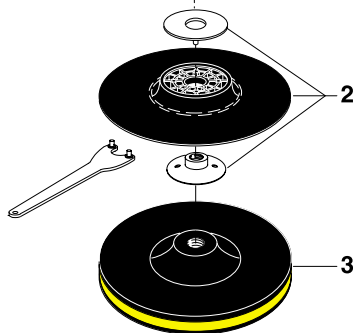
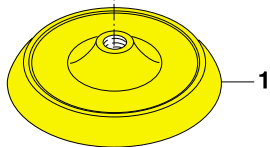

KA90..A / KA90..B

ACCESSORIES INCLUDED

	PART NO.
• Exhaust hose L = 1.5 m (60")	615 875 1130
• Clamp	615 873 415 0
• 3/8" air hose nipple for 10 mm ID hose	615 704 017 0
• Grip	615 576 069 0
• Flat wrench, 17 mm (11/16")	615 801 032 0
• Hex. key 8 mm (5/16")	615 802 061 0
• Water intake system for KA90..A16 and B16	615 396 1130

OPTIONAL ACCESSORIES

ITEM	KA90..A16 and KA90..B16 with water intake	
	KA90..A16 M14x2	KA90..B16 5/8"-11f.
1 Foam pad ø 200 mm (8") (max: 3 000 rpm)	615 990 139 0	615 990 015 0
1 Foam pad ø 180 mm (7") (max: 3 200 rpm)	615 990 140 0	615 990 144 0
1 Foam pad ø 150 mm (6") (max: 3 800 rpm)	615 990 135 0	615 990 136 0

All pads are medium hardness, with a centre hole

ITEM	Sanding	
	KA90..A M14x2	KA90..B 5/8"-11f.
2 Soft backing pad with nut M14 and 5/8" ø 180 mm (7") (max: 8 500 rpm)	615 990 133 0	615 990 133 0
2 Rigid backing pad with nut M14 and 5/8" ø 180 mm (7") (max: 8 500 rpm)	615 990 134 0	615 990 134 0
• Pin wrench, 35 mm (1-3/8")	615 802 010 0	615 802 010 0
3 Rigid velcro-backed backing pad ø 180 mm (7") (max: 8 700 rpm)	615 990 145 0	615 990 146 0
3 Rigid velcro-backed backing pad ø 150 mm (6") (max: 10 000 rpm)	615 990 137 0	615 990 138 0

ITEM	Polishing	
	KA9020A M14x2	KA9020B 5/8"-11f.
2 Soft backing pad with nut M14 and 5/8" ø 180 mm (7") (max: 8 500 rpm)	615 990 133 0	615 990 133 0
• Pin wrench, 35 mm (1-3/8")	615 802 010 0	615 802 010 0
4 Sheepskin ø 180 mm (7") (max: 2 100 rpm)	615 845 999 0	615 845 999 0

OTHER OPTIONAL ACCESSORIES

ITEM	PART NO.
5 Complete silencer kit	615 396 166 0
6 Inlet hose assembly L = 1.7 m (67") 3/8"M - 3/8"F ø 10 mm	615 870 210 0
7 Reinforced cloth-lined exhaust hose L = 0.75 m (30")	615 875 116 0
8 Side handle	615 576 038 0
9 Vibration-damping side handle	615 576 066 0

Sanders for abrasive discs sheepskin and water sanding Ø 150 mm (6") - Ø 180 mm (7") - Ø 200 mm (8") 900 Watts (1.21 hp) - 2 000 - 3 000 rpm

Supplied with M14 or 5/8" threaded spindle only

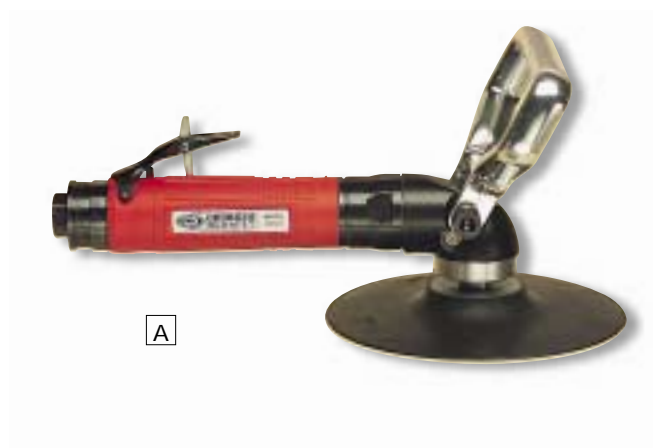

A



B

With water intake
in the pad centre



Caution: comply with the speeds recommended by component and abrasive manufacturers

PICTURE REF	MODEL	PART NUMBER	FREE	THREADED	POWER		WEIGHT		AIR CONSUMPTION				AIR	HOSE
			SPEED	SPINDLE	W	hp	kg	lb.	AT FREE SPEED	AT MAX OUTPUT	INLET THREAD	INT. Ø		
			rpm						l/s	cfm	l/s	cfm	inch	mm
A	KA9030A	615 170 098 0	3000	M14x2	900	1.21	1.6	3.5	13	27	17	36	38	10
A	KA9030B	615 170 099 0	3000	5/8"-11f.	900	1.21	1.6	3.5	13	27	17	36	38	10
A	KA9020A	615 170 096 0	2000	M14x2	900	1.21	1.6	3.5	7	15	17	36	38	10
A	KA9020B	615 170 097 0	2000	5/8"-11f.	900	1.21	1.6	3.5	7	15	17	36	38	10
B	KA9030A16	615 170 102 0	3000	M14x2	900	1.21	2.0	4.4	13	27	17	36	38	10
B	KA9030B16	615 170 103 0	3000	5/8"-11f.	900	1.21	2.0	4.4	13	27	17	36	38	10
B	KA9020A16	615 170 100 0	2000	M14x2	900	1.21	2.0	4.4	7	15	17	36	38	10
B	KA9020B16	615 170 101 0	2000	5/8"-11f.	900	1.21	2.0	4.4	7	15	17	36	38	10

Accessories

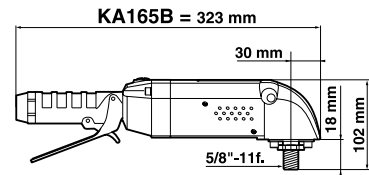
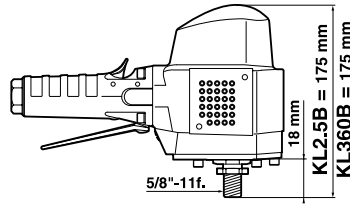
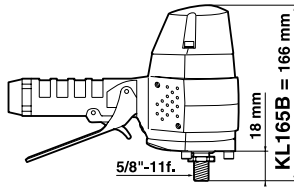

KL165B / KL245B / KL265B / KL360B / KA165B

ACCESSORIES INCLUDED

	KL165B	KL2.5B KL360B	KA165B
• Rear flange	615 503 107 0	615 503 107 0	615 503 107 0
• 1/2" air hose nipple for 13 mm ID hose	615 704 016 0		
• 1/2" air hose nipple for 15 mm ID hose		615 704 014 0	615 704 014 0
• Vibration-damping side handle	-	-	615 576 066 0

OPTIONAL ACCESSORIES

	KL2.5B KL360B	KL165B KA165B
Sanding with standard abrasive disc ø 180 mm (7")		
A Sanding kit for abrasive disc (including Item 1)	615 396 131 0	615 396 131 0
1 Soft backing pad with nut (max: 8 500 rpm)	615 990 133 0	615 990 133 0
• Pin wrench, 35 mm (1-3/8")	615 802 010 0	615 802 010 0
• Hex. key 8 mm (5/16")	615 802 061 0	615 802 061 0

	KL2.5B
Sanding with standard abrasive disc ø 230 mm (9")	
B Sanding kit for abrasive disc (including Item 2)	615 396 134 0
2 Soft backing pad with nut (max: 6 500 rpm)	615 990 141 0
• Pin wrench, 35 mm (1-3/8")	615 802 010 0
• Hex. key 8 mm (5/16")	615 802 061 0

OTHER OPTIONAL ACCESSORIES

	KL2.5B		
3 Rigid backing pad with nut ø 180 mm (7") (max: 8 500 rpm)	615 990 134 0	615 990 134 0	615 990 134 0
C Silencer kit	615 399 227 0	615 396 117 0	
D Silencer kit	615 399 460 0	615 399 462 0	
E Silencer kit			615 399 298 0
F Silencer kit			615 399 459 0

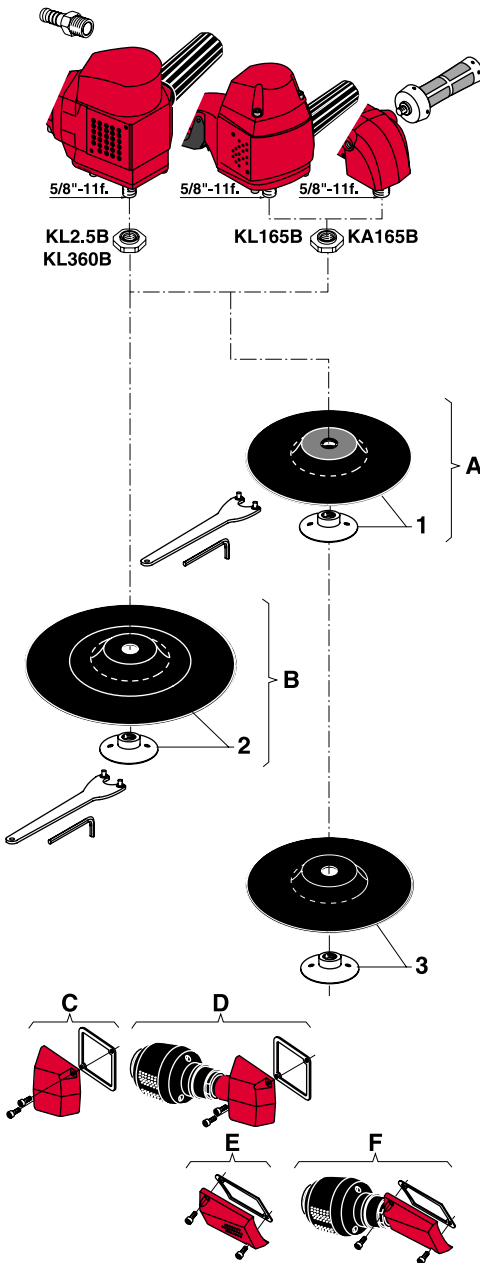

Sanders for abrasive discs

∅ 180 mm (7") - ∅ 230 mm (9")

1 200 to 2 700 Watts (1.61 to 3.62 hp) - 4 500 to 6 500 rpm

Supplied with 5/8" threaded spindle only



A



B



C

Caution: comply with the speeds recommended by component and abrasive manufacturers

PICTURE REF	MODEL	PART NUMBER	FREE SPEED	ABRASIVE MAX CAPACITY		THREADED SPINDLE	POWER		WEIGHT		AIR CONSUMPTION AT FREE SPEED		AIR CONSUMPTION AT MAX OUTPUT		AIR INLET THREAD	HOSE INT. Ø
				mm	inch		W	hp	kg	lb.	l/s	cfm	l/s	cfm		
VERTICAL SANDERS																
A	KL165B	615 1700110	6500	∅180	7	5/8-11f.	1200	1.61	2.3	5.1	6	13	25	53	1/2	13
B	KL245B	615 1700140	4500	∅230	9	5/8-11f.	2000	2.70	3.5	7.7	7	15	32	68	1/2	15
B	KL265B	615 1700230	6500	∅230	9	5/8-11f.	2200	3.00	3.5	7.7	11	23	41	87	1/2	15
B	KL360B	615 1700240	6000	∅230	9	5/8-11f.	2700	3.62	3.7	8.2	12	25	43	91	1/2	15
ANGLE SANDER																
C	KA165B	615 1700250	6500	∅180	7	5/8-11f.	1200	1.61	2.3	5.1	11	23	25	53	1/2	15

Accessories

K1..B6 = 492 mm

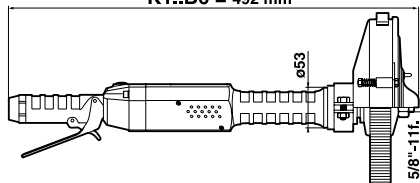

K2..B6 / K3..B6 = 554 mm

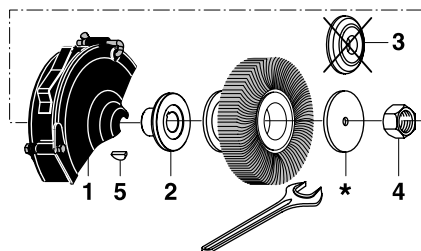
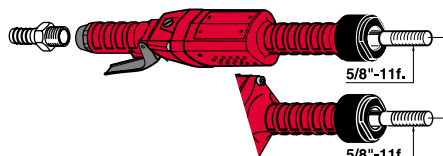
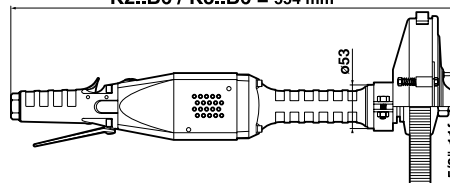

K145B6 / K160B6 / K260B6 / K360B6

ACCESSORIES INCLUDED

ITEM	PART NO.
• 1/2" air hose nipple for 15 mm ID hose	615 704 014 0
1 Wheel guard	615 504 079 0
2 Rear flange	615 503 028 0
3 Front flange	615 502 027 0
4 Nut	615 608 006 0
5 Woodruff key	615 630 019 0
• Flat wrench 27 mm (1-1/16")	615 801 077 0

* Flange supplied with flap wheel. To be drilled to fit the diameter of the output shaft of the tool.

OPTIONAL ACCESSORIES

ITEM	K145B6	K260B6
	K160B6	K360B6
A Silencer kit	615 399 298 0	
B Silencer kit	615 399 459 0	
C Silencer kit		615 399 227 0
D Silencer kit		615 399 460 0

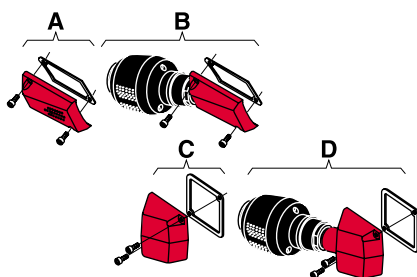

Polishing machines for flap wheels

Ø 165 mm (6-5/8")

1 000 to 2 700 Watts (1.34 to 3.62 hp) - 4 500 - 6 000 rpm



A



B

Other characteristics, see page 23

Caution: comply with the speeds recommended by component and abrasive manufacturers

PICTURE REF	MODEL	PART NUMBER	To be USED with FLAP WHEEL	FREE	THREAD	POWER		WEIGHT	
				SPEED	SPINDLE	W	hp	kg	lb.
				rpm	inch				
A	K145B6	615 170 002 0	Max Ø 165 x 30 x 15.9 mm (6-5/8" x 1-3/16" x 5/8")	4500	5/8-11f.	1000	1.34	3.5	7.7
A	K160B6	615 170 003 0	Max Ø 165 x 30 x 15.9 mm (6-5/8" x 1-3/16" x 5/8")	6000	5/8-11f.	1200	1.61	3.5	7.7
B	K260B6	615 170 008 0	Max Ø 165 x 30 x 15.9 mm (6-5/8" x 1-3/16" x 5/8")	6000	5/8-11f.	2000	2.70	5.1	11.2
B	K360B6	615 170 010 0	Max Ø 165 x 30 x 15.9 mm (6-5/8" x 1-3/16" x 5/8")	6000	5/8-11f.	2700	3.62	5.6	12.3

Accessories

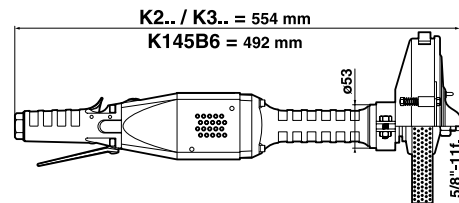
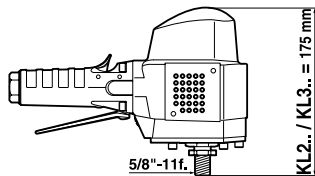
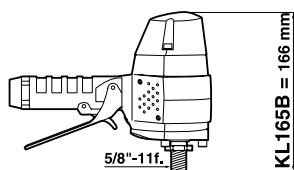

KL165B / KL245B / KL265B / KL360B

ACCESSORIES INCLUDED

	KL 165 B	KL2.5B KL360B
• Rear flange	615 503 107 0	615 503 107 0
• 1/2" air hose nipple for 13 mm ID hose	615 704 016 0	
• 1/2" air hose nipple for 15 mm ID hose		615 704 014 0

OPTIONAL ACCESSORIES

Kit for cup brush, max \varnothing 150 mm (6"), thread 5/8"-11f.

ITEM	PART NO.
• Complete kit (including Item 1-2)	615 396 133 0
1 Allen screw M8x20	615 616 002 0
2 Washer L8	615 642 070 0
• Flat wrench 27 mm (1-1/16")	615 801 077 0
• Hex. key 6 mm	615 802 056 0

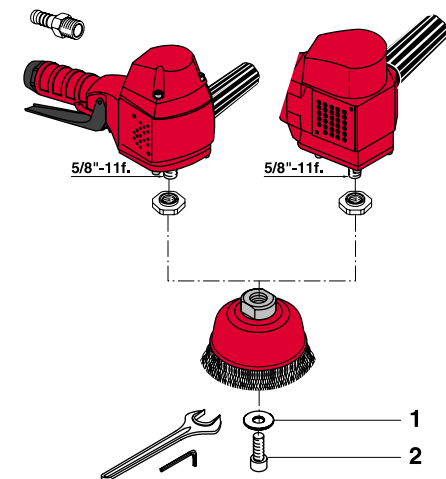

K145B6 / K260B6 / K360B6 / K245B8 / K345B8

ACCESSORIES INCLUDED

ITEM	To be used with radial brush	
	K260/K360B6 K145B6 \varnothing 150 mm (6")	K345B8 K245B8 \varnothing 200 mm (8")
• 1/2" air hose nipple for 15 mm ID hose	615 704 014 0	615 704 014 0
1 Wheel guard	615 504 079 0	615 504 078 0
2 Rear flange	615 503 028 0	615 503 004 0
3 Front flange	615 502 027 0	615 502 007 0
4 Nut	615 608 006 0	615 608 006 0
5 Woodruff key	615 630 019 0	615 630 019 0
• Flat wrench 27 mm (1-1/16")	615 801 077 0	615 801 077 0

OPTIONAL ACCESSORIES

ITEM	K2.. / K3.. KL2.. / KL3..	KL165B	K145B6
A Silencer kit	615 399 227 0	615 396 117 0	
B Silencer kit	615 399 460 0	615 399 462 0	
C Silencer kit			615 399 298 0
D Silencer kit			615 399 459 0

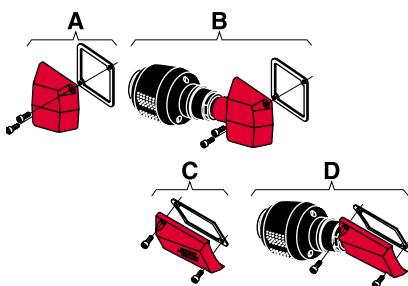
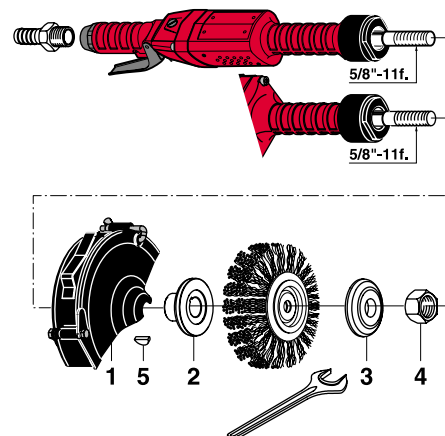

Brushing machines for cup brushes, and radial brushes ø 150 mm (6") - ø 200 mm (8") 1 000 to 2 700 Watts (1.34 to 3.62 hp) - 4 500 to 6 500 rpm



A



B



C

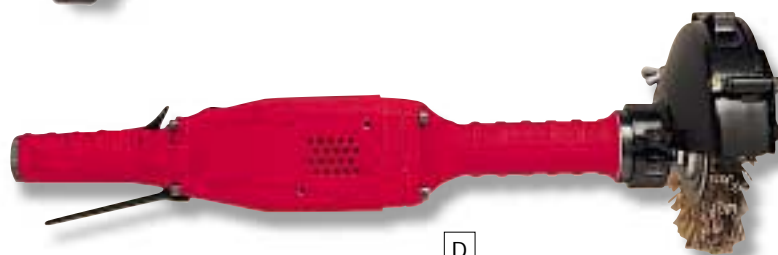

D

Other characteristics, see pages 23 and 33

Caution: comply with the speeds recommended by component and abrasive manufacturers

PICTURE REF	MODEL	PART NUMBER		FREE	THREADED	POWER		WEIGHT		
				SPEED	SPINDLE	W	hp	kg	lb.	
				Max ø 150 mm (6") - Thread 5/8"-11f.	rpm	inch				
VERTICAL MACHINES				TO BE USED WITH CUP BRUSHES						
A	KL165B	615 170 011 0	+	Kit 615 396 133 0	6500	5/8-11f.	1200	1.61	24	5.3
B	KL245B	615 170 014 0	+	Kit 615 396 133 0	4500	5/8-11f.	2000	2.70	35	7.7
B	KL265B	615 170 023 0	+	Kit 615 396 133 0	6500	5/8-11f.	2200	3.00	35	7.7
B	KL360B	615 170 024 0	+	Kit 615 396 133 0	6000	5/8-11f.	2700	3.62	37	8.2
STRAIGHT MACHINES				TO BE USED WITH RADIAL BRUSHES						
C	K145B6	615 170 002 0		Max ø 150 x bore 15.9 mm (6" x 5/8")	4500	5/8-11f.	1000	1.34	35	7.7
D	K260B6	615 170 008 0		Max ø 150 x bore 15.9 mm (6" x 5/8")	6000	5/8-11f.	2000	2.70	51	11.2
D	K360B6	615 170 010 0		Max ø 150 x bore 15.9 mm (6" x 5/8")	6000	5/8-11f.	2700	3.62	56	12.3
D	K245B8	615 170 006 0		Max ø 200 x bore 15.9 mm (8" x 5/8")	4500	5/8-11f.	1800	2.41	58	12.7
D	K345B8	615 170 009 0		Max ø 200 x bore 15.9 mm (8" x 5/8")	4 500	5/8-11f.	2 400	3.22	6.3	13.9

Abrasive accessories

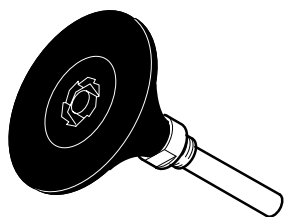

BACKING PAD FOR MECHANICAL MOUNTING DISCS

SPEED rpm	Ø mm	PART NO.
25 000	50	615 804 098 0

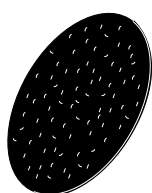

MECHANICAL MOUNTING ABRASIVE DISCS

SPEED rpm	GRIT	PART NO.
25 000	P40	615 804 099 0
25 000	P60	615 804 100 0
25 000	P80	615 804 101 0
25 000	P120	615 804 102 0

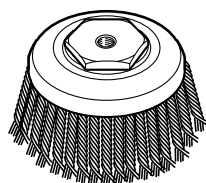

CUP BRUSHES, THREAD 5/8"-11f.

MAX SPEED rpm	Ø mm	TYPE	WIRE Ø mm	PART NO.
6 500	80	Twisted	5/10	615 804 065 0
4 500	100	Undulated	3/10	615 804 073 0
4 500	100	Undulated	5/10	615 804 066 0
6 500	120	Undulated	3/10	615 804 067 0
6 500	120	Twisted	8/10	615 804 068 0
4 500	150	Undulated	3/10	615 804 069 0
4 500	150	Twisted	8/10	615 804 071 0



RADIAL BRUSHES

SPEED MAX rpm	Ø mm	BORE mm	TYPE	WIRE Ø mm	PART NO.
4 500	100	15.8	Undulated	5/10	615 854 155 0
4 500	150	15.8	Undulated	3/10	615 858 153 0

