

Routers

375 Watts (0.5 hp) - 20 000 to 40 000 rpm

CNOMO type collet



Easy removal of chips



615 396 069 0: Machined routing kit for burr, max \varnothing 6.4 mm

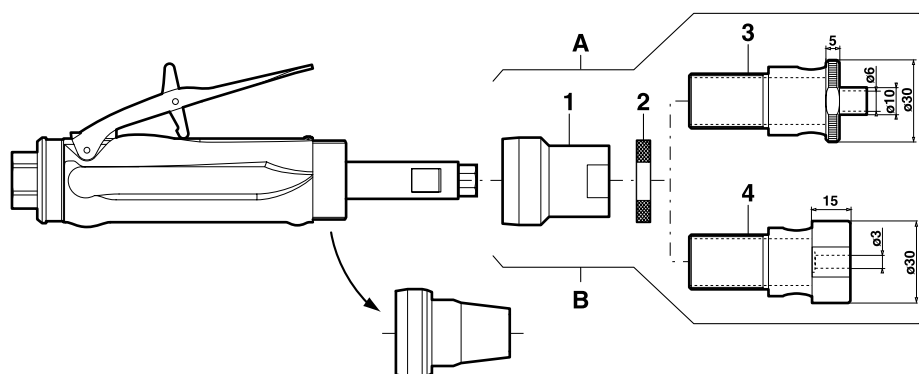

615 396 070 0: Blank routing kit allowing you to adapt the blank to fit the application



ITEM	PART NO.
A Machined routing kit (Item 1-2-3)	615 396 069 0
B Blank routing kit (Item 1-2-4)	615 396 070 0
1 Flange	615 595 231 0
2 Adjusting nut	615 607 140 0
3 Machined routing guide	615 542 125 0
4 Blank routing guide	615 542 125 2

To select a router: rotational speed and routing kit
 For example: 20 000 rpm (KC320-7) + machined kit
 Order: 615 170 029 0 + 615 396 069 0

Caution: comply with the speeds recommended by component and abrasive manufacturers

MODEL	FREE SPEED rpm	POWER		PART NUMBER	ROUTING KIT		
		W	hp		MACHINED	BLANK	
KC340-7	40000	375	0.5	615 170 032 0	+	615 396 069 0	615 396 070 0
KC331-7	31000	375	0.5	615 170 031 0	+		
KC325-7	25000	375	0.5	615 170 030 0	+		
KC320-7	20000	375	0.5	615 170 029 0	+		

Routers

600 - 900 Watts (0.8 - 1.21 hp) - 12 000 to 28 000 rpm

CNOMO type or series 200 collet



Easy removal of chips



615 388 121 0 Routing kit
for burr, \varnothing 6 mm or 6.35 mm (1/4")

615 388 122 0 Blank routing kit
allowing you to adapt the blank to fit the application

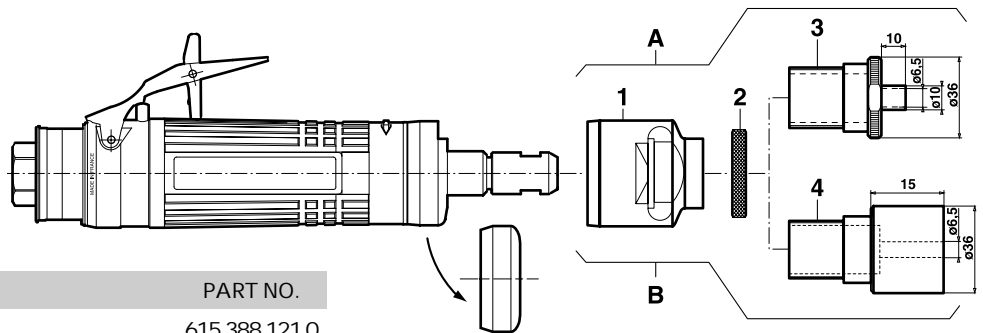



ITEM	PART NO.
A Machined routing kit (Item 1-2-3)	615 388 121 0
B Blank routing kit (Item 1-2-4)	615 388 122 0
1 Flange	615 595 245 0
2 Adjusting nut	615 607 145 0
3 Machined routing guide	615 542 128 0
4 Blank routing guide	615 542 128 2

To select a router: rotational speed and routing kit

Example: Tool with Series 200 - 22 000 rpm collet (KC922-9) + blank kit

Order: 615 170 160 0 + 615 388 122 0

Caution: comply with the speeds recommended by component and abrasive manufacturers

MODEL	FREE SPEED rpm	POWER		PART NUMBER		ROUTING KIT	
		W	hp	CNOMO COLLET (-7)	SERIES 200 COLLET (-9)	MACHINED	BLANK
KC628-	28000	600	0.80	615 170 126 0	615 170 158 0		
KC624-	24000	600	0.80	615 170 125 0	615 170 159 0		
KC922-	22000	900	1.21	615 170 130 0	615 170 160 0		
KC619-	19000	600	0.80	615 170 124 0	615 170 161 0		
KC918-	18000	900	1.21	615 170 129 0	615 170 162 0		
KC615-	15000	600	0.80	615 170 123 0	615 170 163 0		
KC915-	15000	900	1.21	615 170 128 0	615 170 164 0		
KC912-	12000	900	1.21	615 170 127 0	615 170 165 0		

Accessories

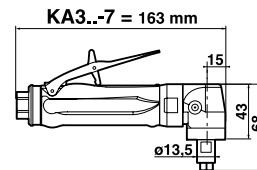
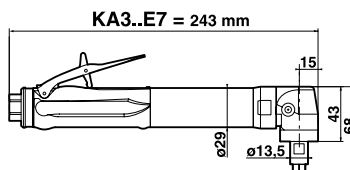
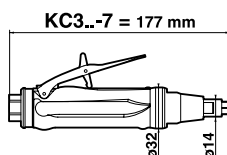
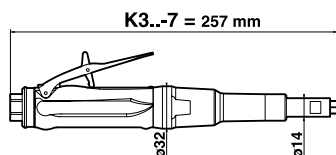

K3.-7 / KC3.-7 / KA3..E7 / KA3.-7

ACCESSORIES INCLUDED

	PART NO.
• CNOMO collet ϕ 6 mm	615 526 046 0
• Exhaust hose L = 0.8 m (31")	615 875 106 0
• 1/4" air hose nipple for 8 mm ID hose	615 704 019 0
• Flat wrench, 10 mm (25/64")	615 801 002 0
• Flat wrench, 11 mm (7/16")	615 801 003 0

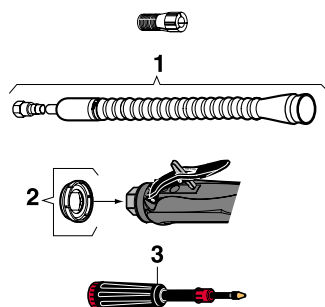
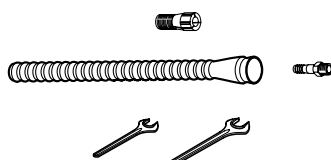

OPTIONAL ACCESSORIES

ITEM	PART NO.
• CNOMO collet ϕ 2.5 mm	615 526 089 0
• CNOMO collet ϕ 3 mm	615 526 044 0
• CNOMO collet ϕ 3.2 mm (1/8")	615 526 045 0
• CNOMO collet ϕ 4 mm (5/32")	615 526 090 0
• CNOMO collet ϕ 4.5 mm	615 526 091 0
• CNOMO collet ϕ 5 mm	615 526 092 0
• CNOMO collet ϕ 6.4 mm (1/4")	615 526 047 0
1 Complete silencer kit	615 396 101 0
2 Clipable silencer	615 396 124 0
3 Grease gun (capacity 24 g.)	615 990 149 0
• Lubricant for bevel gear (1 kg)	615 990 148 0



Grinders for carbide burrs, mounted points and sanding discs

375 Watts (0.5 hp) - 12 000 to 40 000 rpm

Supplied with CNOMO collet, \varnothing 6 mm



A



B



C



D

K3..-7 / KC3..-7 / KA3..E7 / KA3..-7
CNOMO type collet



Caution: comply with the speeds recommended by component and abrasive manufacturers

PICTURE REF	MODEL	PART NUMBER	FREE SPEED	COLLET MAX CAPACITY	POWER		WEIGHT		AIR CONSUMPTION				AIR INLET THREAD	HOSE INT. Ø
					rpm	mm	W	hp	kg	lb.	AT FREE SPEED	AT MAX OUTPUT		
STRAIGHT GRINDERS														
A	K340-7	615 170 036 0	40000	6.4	375	0.5	0.58	1.28	7.5	16.0	10.0	21	1/4	8
A	K331-7	615 170 035 0	31000	6.4	375	0.5	0.58	1.28	4.5	9.5	9.5	20	1/4	8
A	K325-7	615 170 034 0	25000	6.4	375	0.5	0.58	1.28	3.5	7.5	9.5	20	1/4	8
A	K320-7	615 170 033 0	20000	6.4	375	0.5	0.58	1.28	2.5	5.0	8.0	17	1/4	8
B	KC340-7	615 170 032 0	40000	6.4	375	0.5	0.40	0.88	7.5	16.0	10.0	21	1/4	8
B	KC331-7	615 170 031 0	31000	6.4	375	0.5	0.40	0.88	4.5	9.5	9.5	20	1/4	8
B	KC325-7	615 170 030 0	25000	6.4	375	0.5	0.40	0.88	3.5	7.5	9.5	20	1/4	8
B	KC320-7	615 170 029 0	20000	6.4	375	0.5	0.40	0.88	2.5	5.0	8.0	17	1/4	8
ANGLE GRINDERS														
C	KA320E7	615 170 047 0	20000	6.4	375	0.5	0.60	1.32	6.5	13.5	10.0	21	1/4	8
C	KA312E7	615 170 039 0	12000	6.4	375	0.5	0.60	1.32	3.0	6.5	9.0	19	1/4	8
D	KA320-7	615 170 043 0	20000	6.4	375	0.5	0.50	1.10	6.5	13.5	10.0	21	1/4	8
D	KA312-7	615 170 037 0	12000	6.4	375	0.5	0.50	1.10	3.0	6.5	9.0	19	1/4	8

Accessories

K6..-7 / K9..-7 = 363 mm

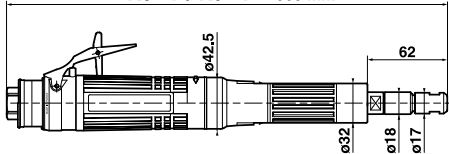

KC6..-7 / KC9..-7 = 222 mm

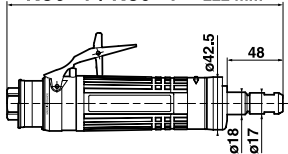

K912-300-7 = 603 mm

K912-500-7 = 853 mm

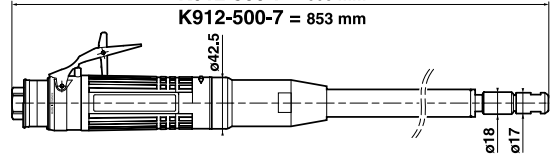

K6..-7 / K9..-7 / KC6..-7 / KC9..-7

ACCESSORIES INCLUDED

	PART NO.
• CNOMO collet \varnothing 6 mm	615 526 049 0
• Exhaust hose L = 1.5 m (60")	615 875 113 0
• Clamp	615 873 415 0
• 3/8" air hose nipple for 10 mm ID hose	615 704 017 0
• Flat wrench, 14 mm (Qty 2)	615 801 005 0

OPTIONAL ACCESSORIES

ITEM	PART NO.
• Collet-holder extension L = 28 mm	615 523 019 0
• CNOMO collet \varnothing 3 mm	615 526 048 0
• CNOMO collet \varnothing 6.35 mm (1/4")	615 526 050 0
• CNOMO collet \varnothing 8 mm	615 526 051 0
1 Complete silencer kit	615 396 166 0
2 Inlet hose assembly L = 1.7 m (67") 3/8"M - 3/8"F - \varnothing 10 mm	615 870 210 0
3 Reinforced cloth-lined exhaust hose L = 0.75 m (30")	615 875 116 0

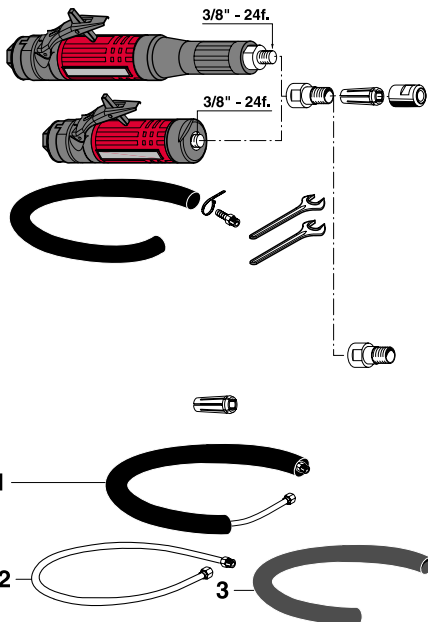

Grinders for carbide burrs and mounted points

600 - 900 Watts (0.8 - 1.21 hp) - 12 000 to 28 000 rpm

Supplied with CNOMO collet, \varnothing 6 mm



A



B



C



D

K6..-7 / KC6..-7 / K9..-7 / KC9..-7
CNOMO type collet



Caution: comply with the speeds recommended by component and abrasive manufacturers

PICTURE REF	MODEL	PART NUMBER	FREE	COLLET	POWER		WEIGHT		AIR CONSUMPTION				AIR	HOSE
			SPEED	MAX CAPACITY	W	hp	kg	lb.	AT FREE SPEED	AT MAX OUTPUT	INLET THREAD	INT. Ø		
			rpm	mm					l/s	cfm	l/s	cfm	inch	mm
A	K628-7	615 170 107 0	28000	8	600	0.80	1.3	2.9	16	34	15	32	3/8	10
A	K624-7	615 170 106 0	24000	8	600	0.80	1.3	2.9	10	21	15	32	3/8	10
A	K922-7	615 170 119 0	22000	8	900	1.21	1.4	3.1	13	28	18	38	3/8	10
A	K619-7	615 170 105 0	19000	8	600	0.80	1.3	2.9	6	13	15	32	3/8	10
A	K918-7	615 170 117 0	18000	8	900	1.21	1.4	3.1	10	21	18	38	3/8	10
A	K615-7	615 170 104 0	15000	8	600	0.80	1.3	2.9	6	13	15	32	3/8	10
A	K915-7	615 170 114 0	15000	8	900	1.21	1.4	3.1	8	17	17	36	3/8	10
A	K912-7	615 170 110 0	12000	8	900	1.21	1.4	3.1	6	13	16	34	3/8	10
B	KC628-7	615 170 126 0	28000	8	600	0.80	0.9	2.0	16	34	15	32	3/8	10
B	KC624-7	615 170 125 0	24000	8	600	0.80	0.9	2.0	10	21	15	32	3/8	10
B	KC922-7	615 170 130 0	22000	8	900	1.21	1.0	2.2	13	28	18	38	3/8	10
B	KC619-7	615 170 124 0	19000	8	600	0.80	0.9	2.0	6	13	15	32	3/8	10
B	KC918-7	615 170 129 0	18000	8	900	1.21	1.0	2.2	10	21	18	38	3/8	10
B	KC615-7	615 170 123 0	15000	8	600	0.80	0.9	2.0	6	13	15	32	3/8	10
B	KC915-7	615 170 128 0	15000	8	900	1.21	1.0	2.2	8	17	17	36	3/8	10
B	KC912-7	615 170 127 0	12000	8	900	1.21	1.0	2.2	6	13	16	34	3/8	10
C	K912-300-7	615 170 108 0	12000	8	900	1.21	2.1	4.6	6	13	16	34	3/8	10
D	K912-500-7	615 170 109 0	12000	8	900	1.21	2.7	5.9	6	13	16	34	3/8	10

Accessories

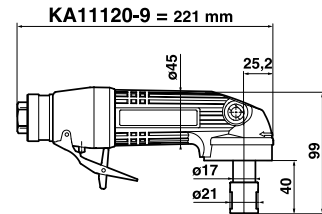
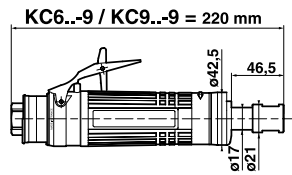
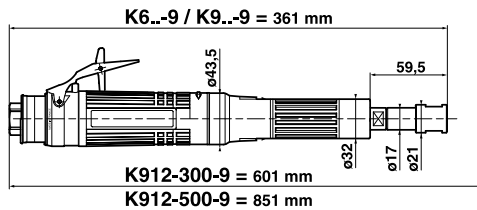

K6..-9 / K9..-9 / KC6..-9 / KC9..-9 / KA11120-9

ACCESSORIES INCLUDED

	PART NO.
• Series 200 resilient collet, \varnothing 5.55 to 6.35 mm (1/4")	615 526 063 0
• Exhaust hose L = 1.5 m (60")	615 875 113 0
• Clamp	615 873 415 0
• 3/8" air hose nipple for 10 mm ID hose	615 704 017 0
• 3/8" air hose nipple for 13 mm ID hose for KA11120-9	616 704 027 0
• Flat wrench, 14 mm	615 801 005 0
• Flat wrench, 19 mm (3/4")	615 801 076 0
• Side handle for KA11120-9	615 576 038 0

OPTIONAL ACCESSORIES

ITEM	PART NO.
• Series 200 resilient collet, \varnothing 2.4 to 3.2 mm (1/8")	615 526 061 0
• Series 200 resilient collet, \varnothing 5.2 to 6 mm	615 526 062 0
• Series 200 resilient collet, \varnothing 7.2 to 8 mm	615 526 064 0
• Series 200 resilient collet, \varnothing 8.7 to 9.5 mm (3/8")	615 526 065 0
1 Vibration-damping handle for KA11120-9	615 576 066 0
2 Insulating sleeve for KA11120-9	615 570 412 0
3 Complete silencer kit	615 396 166 0
4 Inlet hose assembly L = 1.7 m (67") 3/8"M - 3/8"F - \varnothing 10 mm	615 870 210 0
4 Inlet hose assembly L = 1.7 m (67") 3/8"M - 3/8"F \varnothing 13 mm for KA11120-9	615 804 064 0
5 Reinforced cloth-lined exhaust hose L = 0.75 m (30")	615 875 116 0

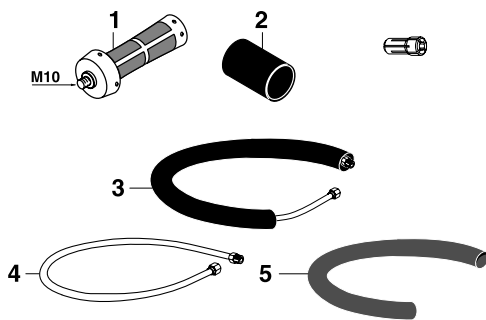
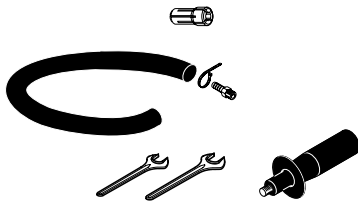

Grinders for carbide burrs, mounted points and sanding discs

600 to 1100 Watts (0.8 to 1.5 hp) - 12 000 to 28 000 rpm

Supplied with series 200 resilient collet, \varnothing 5.55 to 6.35 mm (1/4")



A



B



C



D



E

K6..-9 / K9..-9 / KC6..9 / KC9..9 / KA11120-9

Series 200 collet



Caution: comply with the speeds recommended by component and abrasive manufacturers

PICTURE REF	MODEL	PART NUMBER	FREE	COLLET MAX CAPACITY	POWER		WEIGHT		AIR CONSUMPTION				AIR INLET THREAD	HOSE INT. Ø
			SPEED		W	hp	kg	lb.	AT FREE SPEED	AT MAX OUTPUT	inch	mm		
			rpm	mm					l/s	cfm	l/s	cfm		mm
A	K628-9	615 170 1500	28000	9.5	600	0.80	1.3	2.9	16	34	15	32	3/8	10
A	K624-9	615 170 1510	24000	9.5	600	0.80	1.3	2.9	10	21	15	32	3/8	10
A	K922-9	615 170 1520	22000	9.5	900	1.21	1.4	3.1	13	28	18	38	3/8	10
A	K619-9	615 170 1530	19000	9.5	600	0.80	1.3	2.9	6	13	15	32	3/8	10
A	K918-9	615 170 1540	18000	9.5	900	1.21	1.4	3.1	10	21	18	38	3/8	10
A	K615-9	615 170 1550	15000	9.5	600	0.80	1.3	2.9	6	13	15	32	3/8	10
A	K915-9	615 170 1560	15000	9.5	900	1.21	1.4	3.1	8	17	17	36	3/8	10
A	K912-9	615 170 1570	12000	9.5	900	1.21	1.4	3.1	6	13	16	34	3/8	10
B	KC628-9	615 170 1580	28000	9.5	600	0.80	0.9	2.0	16	34	15	32	3/8	10
B	KC624-9	615 170 1590	24000	9.5	600	0.80	0.9	2.0	10	21	15	32	3/8	10
B	KC922-9	615 170 1600	22000	9.5	900	1.21	1.0	2.2	13	28	18	38	3/8	10
B	KC619-9	615 170 1610	19000	9.5	600	0.80	0.9	2.0	6	13	15	32	3/8	10
B	KC918-9	615 170 1620	18000	9.5	900	1.21	1.0	2.2	10	21	18	38	3/8	10
B	KC615-9	615 170 1630	15000	9.5	600	0.80	0.9	2.0	6	13	15	32	3/8	10
B	KC915-9	615 170 1640	15000	9.5	900	1.21	1.0	2.2	8	17	17	36	3/8	10
B	KC912-9	615 170 1650	12000	9.5	900	1.21	1.0	2.2	6	13	16	34	3/8	10
C	K912-300-9	615 170 1690	12000	9.5	900	1.21	2.1	4.6	6	13	16	34	3/8	10
D	K912-500-9	615 170 1700	12000	9.5	900	1.21	2.7	5.9	6	13	16	34	3/8	10
E	KA11120-9	615 170 0600	12000	9.5	1100	1.50	1.4	3.1	10	21	19	40	3/8	13