

Sanders for expandable wheels, flap wheels, brushes...

300 Watts (0.4 hp) - 490 to 5 000 rpm

Supplied with 3/8" threaded spindle only



A

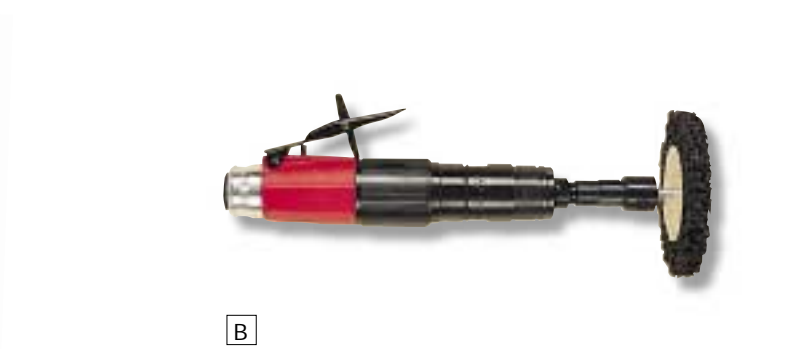

B



C



D

Caution: comply with the speeds recommended by component and abrasive manufacturers

PICTURE REF	MODEL	PART NUMBER	FREE SPEED rpm	COLLET MAX CAPACITY mm	THREADED SPINDLE inch	POWER		WEIGHT		AIR CONSUMPTION AT FREE SPEED		AIR INLET THREAD inch	HOSE INT. Ø mm
						W	hp	kg	lb.	l/s	cfm		
STRAIGHT SANDERS													
A	D6.48C	615 176 016 0	5000	9.5	3/8-24f.	300	0.4	0.65	1.4	8	17	1/4	6
A	D6.32C	615 176 013 0	3100	9.5	3/8-24f.	300	0.4	0.65	1.4	8	17	1/4	6
A	D6.21C	615 176 010 0	2200	9.5	3/8-24f.	300	0.4	0.65	1.4	8	17	1/4	6
B	D6.13C	615 176 007 0	1400	9.5	3/8-24f.	300	0.4	0.80	1.8	8	17	1/4	6
B	D6.9C	615 176 005 0	800	9.5	3/8-24f.	300	0.4	0.80	1.8	8	17	1/4	6
B	D6.5C	615 176 003 0	490	9.5	3/8-24f.	300	0.4	0.80	1.8	8	17	1/4	6
COMPOSITE HANDLE SANDERS													
C	PC6.48C	615 176 018 0	4900	9.5	3/8-24f.	300	0.4	0.69	1.5	10	21	1/4	8
C	PC6.32C	615 176 015 0	3000	9.5	3/8-24f.	300	0.4	0.69	1.5	10	21	1/4	8
C	PC6.21C	615 176 012 0	2100	9.5	3/8-24f.	300	0.4	0.69	1.5	10	21	1/4	8
D	PC6.13C	615 176 009 0	1300	9.5	3/8-24f.	300	0.4	0.83	1.8	10	21	1/4	8

Accessories

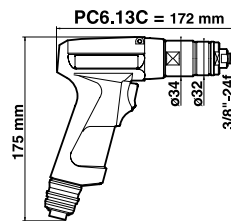
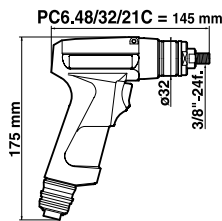
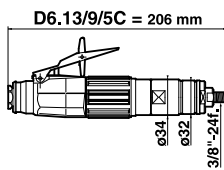
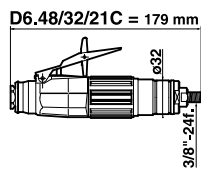

D6...C / PC6...C

ACCESSORIES INCLUDED

- 1/4" air hose nipple for 6 mm ID hose D6...C
- 1/4" air hose nipple for 8 mm ID hose PC6...C

PART NO.

615 705 009 0
615 704 019 0

OPTIONAL ACCESSORIES

ITEM

ITEM	PART NO.
1 Series 200 collet-holder	615 523 023 0
2 Series 200 resilient collet, \varnothing 2.4 to 3.2 mm (1/8")	615 526 061 0
2 Series 200 resilient collet, \varnothing 5.2 to 6 mm	615 526 062 0
2 Series 200 resilient collet, \varnothing 5.55 to 6.35 mm (1/4")	615 526 063 0
2 Series 200 resilient collet, \varnothing 7.2 to 8 mm	615 526 064 0
2 Series 200 resilient collet, \varnothing 8.7 to 9.5 mm (3/8")	615 526 065 0
3 Collet nut	615 607 144 0
4 Key-lock chuck, capacity 0 to 6 mm (Weight 0.14 kg)	615 804 415 0
4 Key-lock chuck, capacity 1 to 10 mm (Weight 0.26 kg)	615 804 417 0
5 Self-locking chuck, capacity 0 to 8 mm (Weight 0.28 kg)	615 804 416 0
5 Self-locking chuck, capacity 1 to 10 mm (Weight 0.37 kg)	615 804 418 0
6 Complete silencer kit	615 399 423 0
7 Exhaust hose L = 0.80 m (31")	615 875 106 0
• Flat wrench, 14 mm	615 801 005 0
• Flat wrench, 19 mm (3/4")	615 801 076 0

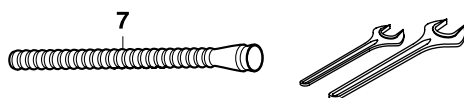
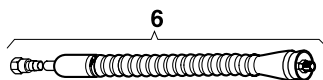
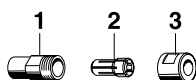

Sanders for expandable wheels, flap wheels, brushes...

900 Watts (1.21 hp) - 1 000 to 5 500 rpm

Supplied with series 200 resilient collet, \varnothing 5.55 to 6.35 mm (1/4")



A



B

Series 200 collet



Caution: comply with the speeds recommended by component and abrasive manufacturers

PICTURE REF	MODEL	PART NUMBER	FREE	COLLET	POWER		WEIGHT		AIR CONSUMPTION				AIR	HOSE
			SPEED	MAX CAPACITY	W	hp	kg	lb.	AT FREE SPEED	AT MAX CAPACITY	INLET THREAD	INT. Ø		
			rpm	mm					l/s	cfm	l/s	cfm	inch	mm
A	KC9060-9	615 170 166 0	5500	9.5	900	1.21	1.38	3.0	10	21	16	34	3/8	10
A	KC9035-9	615 170 167 0	3500	9.5	900	1.21	1.38	3.0	6	13	14	30	3/8	10
B	KC9010-9	615 170 168 0	1000	9.5	900	1.21	1.45	3.2	10	21	16	34	3/8	10

Sanders for expandable wheels, flap wheels, brushes...

900 Watts (1.21 hp) - 1 000 to 5 500 rpm

Supplied with CNOMO collet, \varnothing 6 mm



A



B

CNOMO type collet



Caution: comply with the speeds recommended by component and abrasive manufacturers

PICTURE REF	MODEL	PART NUMBER	FREE	COLLET	POWER		WEIGHT		AIR CONSUMPTION				AIR	HOSE
			SPEED	MAX CAPACITY	W	hp	kg	lb.	AT FREE SPEED	AT MAX CAPACITY	INLET THREAD	INT. Ø		
			rpm	mm					l/s	cfm	l/s	cfm	inch	mm
A	KC9060-7	615 170 122 0	5500	8	900	1.21	1.38	3.0	10	21	16	34	3/8	10
A	KC9035-7	615 170 121 0	3500	8	900	1.21	1.38	3.0	6	13	14	30	3/8	10
B	KC9010-7	615 170 120 0	1000	8	900	1.21	1.45	3.2	10	21	16	34	3/8	10

Accessories

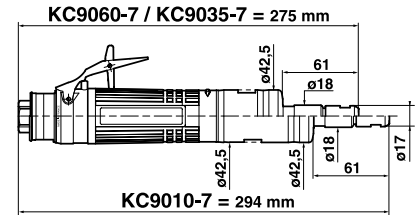
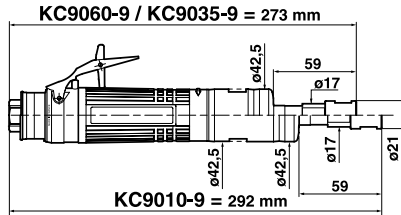

KC9060-9 / KC9035-9 / KC9010-9

ACCESSORIES INCLUDED

	PART NO.
• Series 200 resilient collet, \varnothing 5.55 to 6.35 mm (1/4")	615 526 063 0
• Exhaust hose L = 1.5 m (60")	615 875 113 0
• Clamp	615 873 415 0
• 3/8" air hose nipple for 10 mm ID hose	615 704 017 0
• Flat wrench, 14 mm	615 801 005 0
• Flat wrench, 19 mm (3/4")	615 801 076 0
• Side handle	615 576 068 0

OPTIONAL ACCESSORIES

ITEM	PART NO.
• Series 200 resilient collet, \varnothing 2.4 to 3.2 mm (1/8")	615 526 061 0
• Series 200 resilient collet, \varnothing 5.2 to 6 mm	615 526 062 0
• Series 200 resilient collet, \varnothing 7.2 to 8 mm	615 526 064 0
• Series 200 resilient collet, \varnothing 8.7 to 9.5 mm (3/8")	615 526 065 0
1 Nut 3/8" - 24 f.	615 608 044 0
2 Complete silencer kit	615 396 166 0
3 Inlet hose assembly L = 1.7 m (67") 3/8"M - 3/8"F - \varnothing 10 mm	615 870 210 0
4 Reinforced cloth-lined exhaust hose L = 0.75 m (30")	615 875 116 0

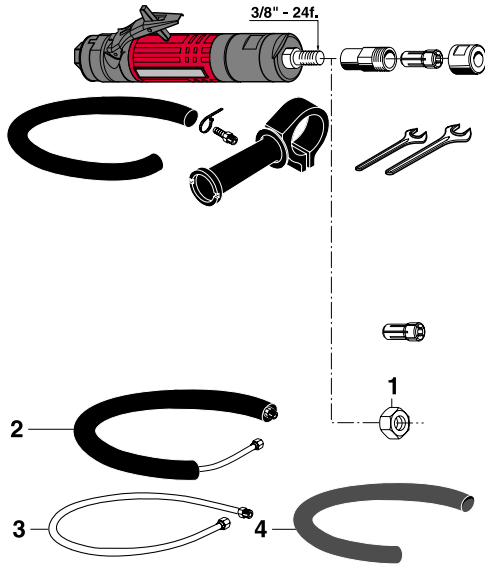

KC9060-7 / KC9035-7 / KC9010-7

ACCESSORIES INCLUDED

	PART NO.
• CNOMO collet \varnothing 6 mm	615 526 049 0
• Exhaust hose L = 1.5 m (60")	615 875 113 0
• Clamp	615 873 415 0
• 3/8" air hose nipple for 10 mm ID hose	615 704 017 0
• Flat wrench, 14 mm (Qty 2)	615 801 005 0
• Side handle	615 576 068 0

OPTIONAL ACCESSORIES

ITEM	PART NO.
• CNOMO collet \varnothing 3 mm	615 526 048 0
• CNOMO collet \varnothing 6.35 mm (1/4")	615 526 050 0
• CNOMO collet \varnothing 8 mm	615 526 051 0
1 Nut 3/8" - 24 f.	615 608 044 0
2 Complete silencer kit	615 396 166 0
3 Inlet hose assembly L = 1.7 m (67") 3/8"M - 3/8"F - \varnothing 10 mm	615 870 210 0
4 Reinforced cloth-lined exhaust hose L = 0.75 m (30")	615 875 116 0

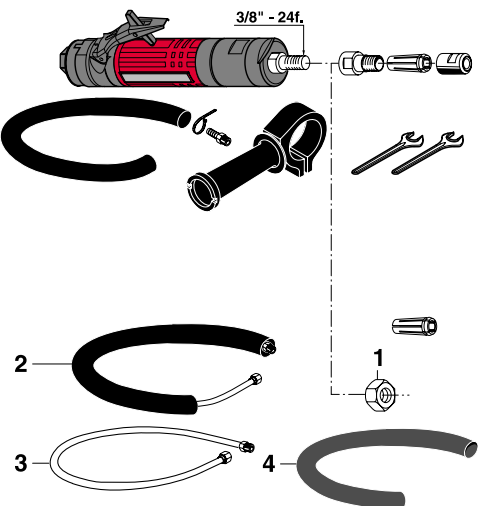

Ponceuses pour disques abrasifs

300 Watts (0.4 hp) - 2 100 à 13 500 tr/min.

Livrées avec pince \varnothing 6 mm - CNOMO

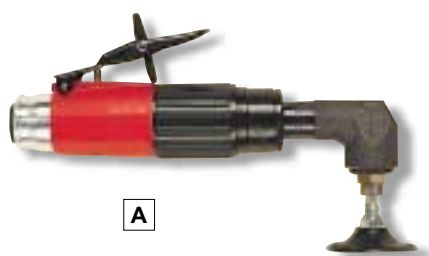

A

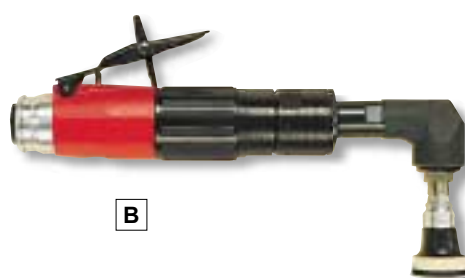

B

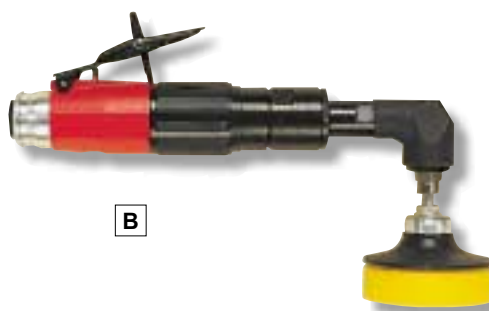

B

Attention : Respecter les vitesses préconisées par les fabricants d'accessoires et d'abrasifs

REP. PHOTOS	MODÈLE	RÉFÉRENCE COMMANDE	VITESSE À VIDE	CAPACITÉ MAXI PINCE	PUISSANCE		MASSE		CONSOMMATION À VIDE		FILETAGE ENTRÉE D'AIR	Ø INT. TUYAU
					W	hp	kg	lb.	l/s	cfm		
A	KLA14	615 170 026 0	13 500	8	300	0.4	0,75	1.7	8	17	1/4	6
B	DA6.35	615 176 019 0	3 500	8	300	0.4	0,90	2.0	8	17	1/4	6
B	DA8.20	615 176 030 0	2 100	8	300	0.4	0,90	2.0	8	17	1/4	6

Accessoires

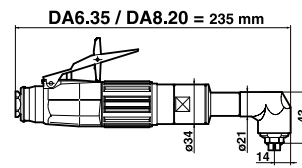
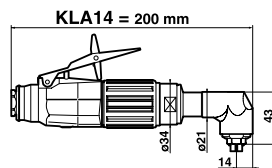

KLA14 / DA6.35 / DA8.20

ACCESSOIRES LIVRÉS AVEC L'OUTIL

	RÉFÉRENCE
• Pince ø 6 mm	615 526 079 0
• Busette 1/4" pour tuyau ø int. 6 mm	615 705 009 0
• Clé plate 10 mm	615 801 002 0
• Clé plate 14 mm	615 801 005 0

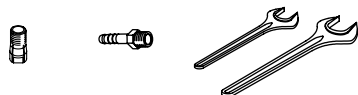

ACCESSOIRES EN OPTION

REP.	RÉFÉRENCE
1 Support ø 50 mm	615 804 098 0
2 Kit silencieux complet	615 399 423 0
3 Tuyau d'admission complet L = 1 m (40") 1/4"M - 1/4"F ø 6 mm	615 870 206 0
4 Gaine d'échappement	615 875 106 0
• Pince ø 2 mm	615 526 066 0
• Pince ø 2,5 mm	615 526 068 0
• Pince ø 3 mm	615 526 069 0
• Pince ø 3,5 mm	615 526 070 0
• Pince ø 4 mm	615 526 071 0
• Pince ø 4,5 mm	615 526 073 0
• Pince ø 5 mm	615 526 075 0
• Pince ø 5,5 mm	615 526 077 0
• Pince ø 6 mm	615 526 079 0
• Pince ø 6,5 mm	615 526 081 0
• Pince ø 7 mm	615 526 083 0
• Pince ø 7,5 mm	615 526 084 0
• Pince ø 8 mm	615 526 088 0

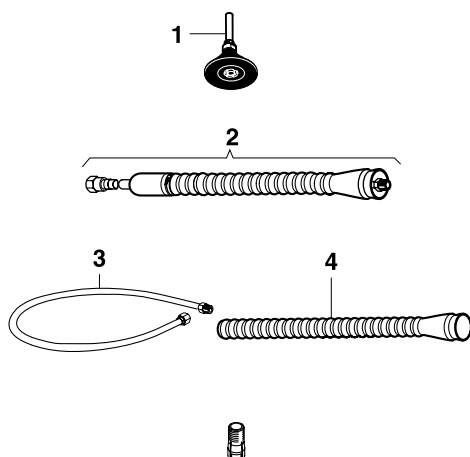

Sanders for abrasive discs

220 - 375 Watts (0.3 - 0.5 hp) - 9 000 to 20 000 rpm

Supplied with 1/4" or 3/8" threaded spindle only



A



B

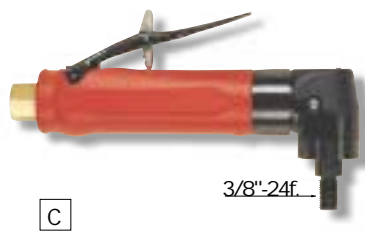

C

3/8"-24f

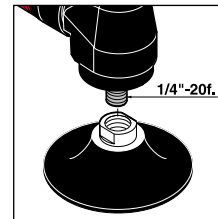

1/4"-20f.

Caution: comply with the speeds recommended by component and abrasive manufacturers

PICTURE REF	MODEL	PART NUMBER	FREE SPEED	ABRASIVE MAX CAPACITY		THREADED SPINDLE	POWER		WEIGHT		AIR CONSUMPTION				AIR INLET THREAD	HOSE INT. Ø
				mm	inch		inch	W	hp	kg	lb.	l/s	cfm	l/s		
A	KA320EG	615 170 048 0	20000	ø76	3	1/4-20f.	375	0.5	0.67	1.47	6.5	13.5	10	21	1/4	8
A	KA312EG	615 170 040 0	12000	ø76	3	1/4-20f.	375	0.5	0.67	1.47	3.0	6.5	9	19	1/4	8
B	KA320G	615 170 044 0	20000	ø76	3	1/4-20f.	375	0.5	0.50	1.10	6.5	13.5	10	21	1/4	8
B	KA312G	615 170 038 0	12000	ø76	3	1/4-20f.	375	0.5	0.50	1.10	3.0	6.5	9	19	1/4	8
B	KA309G	615 170 204 0	9000	ø76	3	1/4-20f.	220	0.3	0.50	1.10	2.2	4.7	8	17	1/4	8
C	KA309C	615 170 203 0	9000	ø76	3	3/8-24f.	220	0.3	0.50	1.10	2.2	4.7	8	17	1/4	8

Accessories

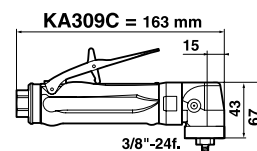
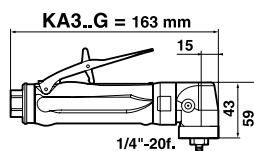
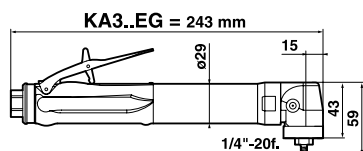

KA3..EG / KA3..G / KA309C

ACCESSORIES INCLUDED

	PART NO.
• Exhaust hose L = 0.8 m (31")	615 875 106 0
• 1/4" air hose nipple for 8 mm ID hose	615 704 019 0
• Flat wrench, 11 mm (7/16")	615 801 003 0

OPTIONAL ACCESSORIES

ITEM	KA309C 3/8"-24f.
1 Eccentric sanding head (available end of 2000)	615 396 251 0

OTHER OPTIONAL ACCESSORIES

ITEM	PART NO.
2 Complete silencer kit	615 396 101 0
3 Clipable silencer	615 396 124 0
4 Grease gun (capacity 24 g.)	615 990 149 0
• Lubricant for bevel gear (1 kg)	615 990 148 0

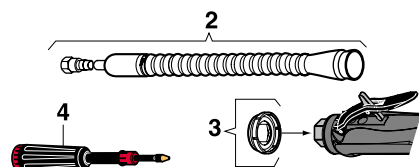
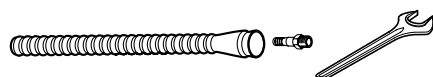

Random orbital polishers with high offset Ø 127 mm (5")

375 Watts (0.5 hp) 10 000 rpm

Supplied with 5/16" F. tapped spindle only



SP3



SP3P

These polishers are balanced to be used with a velcro-backed pad Ø 127 mm (5"), thickness 16 mm (5/8"), weight 100 gr (0.22 lb), fitted with polishing foam, thickness 20 mm, weight 16 gr (0.03 lb).

Caution: comply with the speeds recommended by component and abrasive manufacturers

PAD		MODEL	PART	WEIGHT		CONSUMPTION		AIR INLET THREAD	HOSE INT. Ø
SIZE				NUMBER	kg	lb	AT MAX OUTPUT		
mm	inch							l/s	cfm

POLISHER WITH PALM GRIP

Suction-free									
Ø 127	5	SP3	615 170 198 0	1.2	2.64	11	23	1/4	8

POLISHER WITH HANDLE GRIP

Suction-free									
Ø 127	5	SP3P	615 170 197 0	1.3	2.86	11	23	1/4	8

Accessories

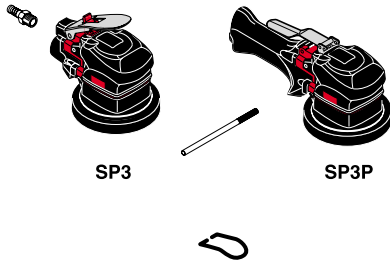
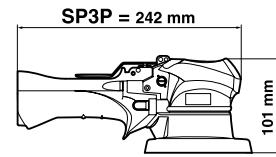
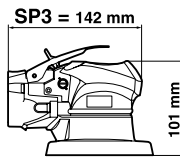

SP3 / SP3P

ACCESSORIES INCLUDED

- 1/4" air hose nipple for 8 mm ID hose
- Clamping lever

PART NO.

615 704 019 0

615 595 202 0

OPTIONAL ACCESSORIES

- Suspension ball

SP3P

615 570 532 0



Abrasive accessories

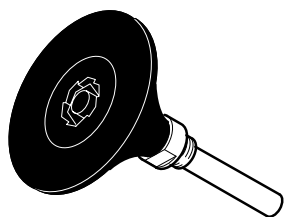

BACKING PAD FOR MECHANICAL MOUNTING DISCS

SPEED rpm	Ø mm	PART NO.
25 000	50	615 804 098 0

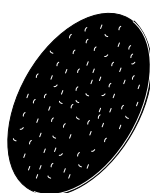

MECHANICAL MOUNTING ABRASIVE DISCS

SPEED rpm	GRIT	PART NO.
25 000	P40	615 804 099 0
25 000	P60	615 804 100 0
25 000	P80	615 804 101 0
25 000	P120	615 804 102 0

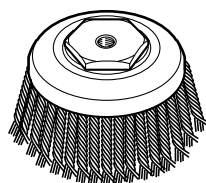

CUP BRUSHES, THREAD 5/8"-11f.

MAX SPEED rpm	Ø mm	TYPE	WIRE Ø mm	PART NO.
6 500	80	Twisted	5/10	615 804 065 0
4 500	100	Undulated	3/10	615 804 073 0
4 500	100	Undulated	5/10	615 804 066 0
6 500	120	Undulated	3/10	615 804 067 0
6 500	120	Twisted	8/10	615 804 068 0
4 500	150	Undulated	3/10	615 804 069 0
4 500	150	Twisted	8/10	615 804 071 0



RADIAL BRUSHES

SPEED MAX rpm	Ø mm	BORE mm	TYPE	WIRE Ø mm	PART NO.
4 500	100	15.8	Undulated	5/10	615 854 155 0
4 500	150	15.8	Undulated	3/10	615 858 153 0

